

SERVICE BOOK

MOUNTING INSTRUCTION OF CONNECTORS



LIST OF CONTENTS

		Page
Symbol legend		4
DC-System (double click)		10
P&R-System (press & ready)		12
Bayonet	2 pin	14
	5 pin	18
	8 pin	22
	15 pin	28
ASS1, ASS2	2 pin	32
ASS1, ASS2, ASS2.1	7 pin	36
ASS3	3 pin	40
	17 pin	44
AMP	4 pin	48
	7 pin	52
SuperSeal	2 pin	56
	3 pin	60
	4 pin	64
	6 pin	68
DEUTSCH connector	2 pin	72
	4 pin	76
Standard connector	8 pin	80
	12 pin	80
Caravan connector	16 pin	82
ISO 1185	7 pin	83
ISO 3731	7 pin	83
ISO 12098	13 pin	84
	15 pin	85
ISO 1724	7 pin	86
ISO 11446	8 pin	87
	13 pin	87
DIN 9680	3 pin	88
VBG	14 pin	89

SYMBOL LEGEND

Symbol					
	Masse	Earth	massa	Masse	Masa
	Blinker links	LH rear direction indicator	freccia sinistra	Clignotant gauche	Intermitente izquierdo
	Blinker rechts	RH rear direction indicator	freccia destra	Clignotant droit	Intermitente derecho
	Bremslicht	stop	stop	Feu stop	Luz de freno
	Standlicht links	LH Tail	posizione sinistra	Feu de position gauche	Luz posición izquierda
	Standlicht rechts	RH Tail	posizione destra	Feu de position droit	Luz posición derecha
	Nebelschlussleuchte	rear fog	retronebbia	Feu de brouillard	Luz antiniebla
	Rückfahrleuchte	reverse	retromarcia	Feu de recul	Luz marcha atrás
	All. Stromversorgung (+)	permanent power supply	positivo permanente	Alimentation électrique permanente (+)	corriente continua
	Achsanhhebung	axle lift	Sollevatore	Relevage d'essieu	dispositivo de elevación del eje
	Federspeicheranzeige	braking control	Controllo funzioamento freni	Contrôle freinage remorque	Control de frenos para trailers
	Verschleißanzeige	brake pad wear Indicator	Controllo usura pastiglie	Témoin d'usure des plaquettes de frein	Indicador de desgaste de las pastillas de freno
	Masse für Elektronen	Earth - Data	Massa per elettronica	Masse des éléments électroniques	masa funciones electrónicas
	freie Wahl	unallocated	libero	Libre	Libre elección

SYMBOL LEGEND

					Symbol
Terra	Massa	Jord	jord	maa	
Pisca esquerdo	knipperlicht Links	Venstre blinklys	blinkler vänster	vilkku vasen	
Pisca direito	knipperlicht Rechts	Høyre blinklys	blinkler höger	vilkku oikea	
Freio	Rem licht	Bremselys	bromsljus	jarruvalo	
Luz de posição esquerda	Achterlamp Links	Venstre parklys	parkljus vänster	parkki vasen	
Luz de posição direita	Achterlamp Rechts	Høyre parklys	parkljus höger	parkki oikea	
Luz de neblina	Mist lamp	Tåkelys	dimljus	sumuvalo	
Luz de Ré	Achteruitrij lamp	Baklys	backljus	peruutusvalo	
corrente contínua	Constante stroomverzorging	Allmenn strømforsyning	allmän strömförsörjning	jatkuva virta	
dispositivo de elevação do eixo	Aslift	Akselløft	axellyft	akselinosto	
Controle de funcionamento dos freios	Remcilinder markering	Bremseindikator	bromsindikator	jousijarrun ilmaisin	
Indicador de desgaste de pastilhas de freio	Remslijtage indicator	Slitasjeindikator	slitageindikator	jarrujen kulumisen ilmaisin	
Terra para funções eletrônicas	Massa Data	Jord for elektronikk	jord för elektronik	elektroniikan maa	
Livre	Vrije positie	Fritt valg	fritt val	vapaa	

SYMBOL LEGEND

Symbol					
	Mass	Masa	Masa	маса	масса
	Vasak suunatuli	Kreisais pagrieziens	Lewy Kierunkowskaz	лівий поворотник	левый поворотник
	Parem suunatuli	Labais pagrieziens	Prawy Kierunkowskaz	правий поворотник	правый поворотник
	Pidurituli	Stop signāls	Światło Stop	стоп-сигнал	стоп-сигнал
	Vasak tagatuli	Kreisais gabarīts	Lewa Pozycja	ліве габаритне світло	левый габаритный свет
	Parem tagatuli	Labais gabarīts	Prawa Pozycja	праве габаритне світло	правый габаритный свет
	Udutuli	Miglas lukturis	Światło Przeciwwłgowe	проти-туманный ліхтар	проти-туманный фонарь
	Tagurdustuli	Atpakaļgaitas lukturis	Światło Cofania	ліхтар заднього ходу	фонарь заднего хода
	Pidev toide	Pastāvīgs spriegums	Stale Zasilanie	постійна напруга	постоянное напряжение питания
	Telje tōste	Paceļamais tilts	Podnoszenie Osi	підйома вісь	подъёмная ось
	Pidurduskontroll	Bremžu kontrole	Kontrola Hamowania	керування гальмуванням	управление торможением
	Piduriklotside kulumise indikaator	Bremžu noduluma sensors	Wskaźnik Zużycia Okładzin Hamulcowych	датчик зносу гальмівних колодок	датчик износа тормозных колодок
	Infokaabli mass	Masa- Dati	Masa Elektroniki	маса електроніки	масса электроники
	Vaba	Brīvais	Wolny	вільний	свободный

SYMBOL LEGEND

Symbol						Symbol
Uzemnění	Uzemnenie	Földelés	masa, ozemljitev	Masa, uzemljenje		
Blinkr levá strana	Smerovka lavá strana	Index, bal	smerokaz levi	Lijevi žmigavac		
Blinkr pravá strana	Smerovka pravá strana	Index, jobb	smerokaz desni	Desni žmigavac		
Brzdové světlo	Brzdové svetlo	Féklámpa	stop luč	Štop svijetlo		
Parkovací světlo levé	Parkovacie svetlo lavé	Helyzetjelző, bal	leva pozicijska luč	Lijevo poziciono svijetlo		
Parkovací světlo pravé	Parkovacie svetlo pravé	Helyzetjelző, jobb	desna pozicijska luč	Desno poziciono svijetlo		
Mlhovka	Hmlové svetlo	Ködlámpa	meglenka	Maglenka		
Zpáteční světlo	Svetlo spiatocky	Tolatólámpa	luč vzratne vožnje	Rikverc svijetlo		
Stálý elektrický proud	Stály elektrický prud	Töltés	napajanje	Napajanje		
Zdvihnutí nápravy	Zdvihnutie nápravy	Tengelyemelés	dvig osi	Podizača osovine		
Kontrola brzdy	Kontrola brzdy	Fékvisszajelző	kontrola zavor	Kontrola kočnica		
Indikátor opotřebení	Indikátor opotrebenia	Fékkopás jelző	indikator obrabe zavor	Indikator potrošnje kočnica		
Uzemnění elektroniky	Uzemnenie elektroniky	Elektr. Földelés	ozemljitev za elektroniko	Uzemljenje za elektroniku		
Volné	Volné	Szabad	odklijeno	Otključano		

SYMBOL LEGEND

Symbol				
	Masa, uzemljenje	Masa, uzemljenje	Masa (impamintare)	заземление
	Lijevi žmigavac	Levi žmigavac	indicator semnalizare stanga	ляв мигач
	Desni žmigavac	Desni žmigavac	indicator semnalizare dreapta	десен мигач
	Štop svijetlo	Štop svetlo	STOP	стоп сингал
	Lijevo poziciono svijetlo	Levo poziciono svetlo	lampa pozitie stanga	габарит ляв
	Desno poziciono svijetlo	Desno poziciono svetlo	lampa pozitie dreapta	габарит десен
	Maglenka	Maglenka	lampa ceata	светлина задна за мъгла
	Rikverc svijetlo	Rikverc svetlo	lampa marsarier	светлини задна скорост
	Napajanje	Napajanje	Alimentare electrica permanenta	постоянно напряжение
	Podizač osovine	Podizač osovine	axa liftanta	повдигане оси
	Kontrola kočnica	Kontrola kočnica	control sistem franare	ръчна спирачка
	Indikator potrošnje kočnica	Indikator potrošnje kočnica	Indicator uzura placate frana	износване на накладките
	Uzemljenje za elektroniku	Uzemljenje za elektroniku	Masa	електроника заземление
	Otključano	Otključano	Liber	свободно

SYMBOL LEGEND

Symbol					Symbol
	Şase, toprak	ارت	الارضى	הארקה	
	Sinyal, sol	راهنما چپ	المؤشر الخلفي لاتجاه اليمين	איתות שמאל	
	Sinyal, sağ	راهنما راست	المؤشر الخلفي لاتجاه اليسار	איתות ימין	
	Fren	چراغ ترمز	توقف	אור בלם	
	Park, sol	چراغ توقف چپ	ضوء الذيل اليسار	חניה שמאל	
	Park, sağ	چراغ توقف راست	ضوء الذيل اليمين	חניה ימין	
	Arka sis	چراغ مه شکن عقب	مزيل الضباب الخلفي	אור ערפל	
	Geri vites	چراغ دنده عقب	اشارة المسير الى الخف	אור נסיעה לאחור/רוורס	
	Sürekli enerji	منبع تغذيه دائمى	امدادات الطاقة دائم - كان ٢٤	הזנה קבועה	
	Dingil kaldırma	بالابر محور	رفع المحور	חיווי הרמת סרן	
	Treyler EBS	کنترول ترمز	اشارة التحكم بالوقوف	חיווי בלם חניה	
	Balata aşınma	نشانگرسایش لنت	اشارة انتهاء صلاحية الكوابح	חיווי בלאי רפידה	
	Şase, elektronik	ارت براي الكترونيك	بيانات الارضى	הארקה אלקטرونيקה	
	Serbest hat	انتخاب آزاد	حالة عدم الربط(حره)	פנוי	

Double Click System - mounting instruction

DC System

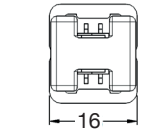
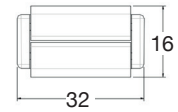

$I_{max}=5A$



IP69K

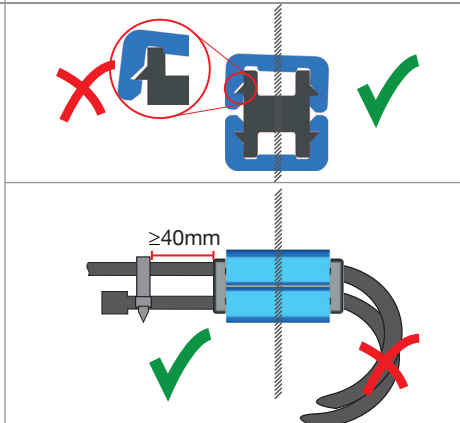
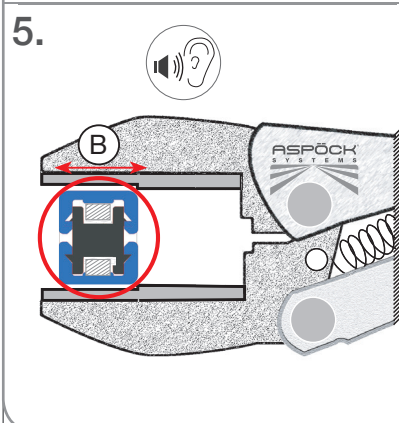
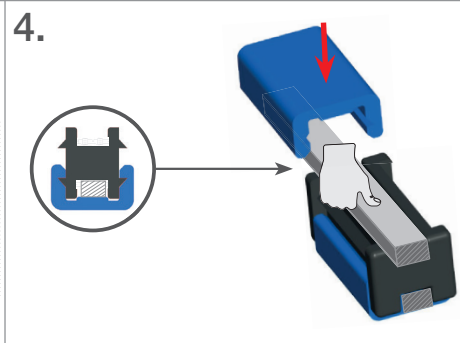
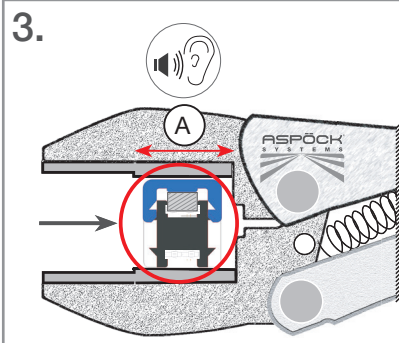
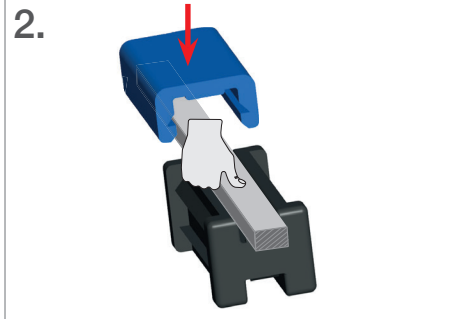
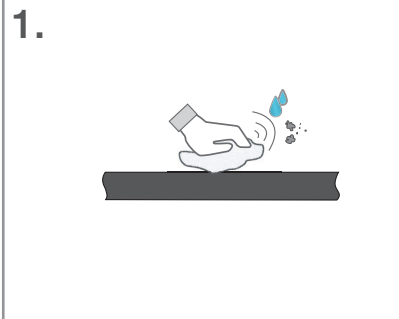
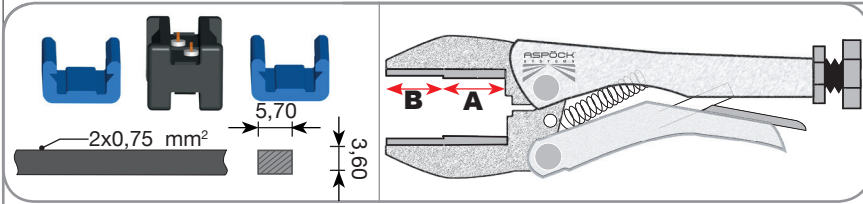

Double Click System - repair instruction

DC System

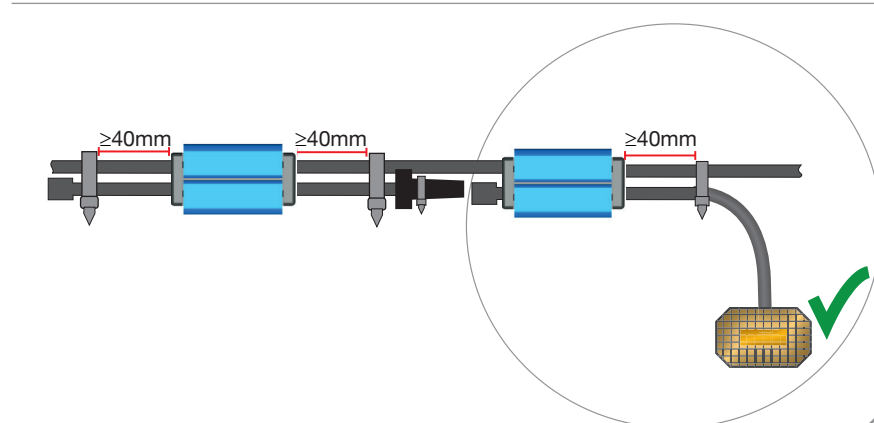
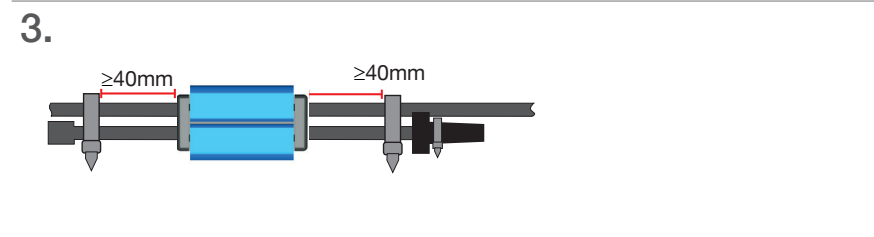
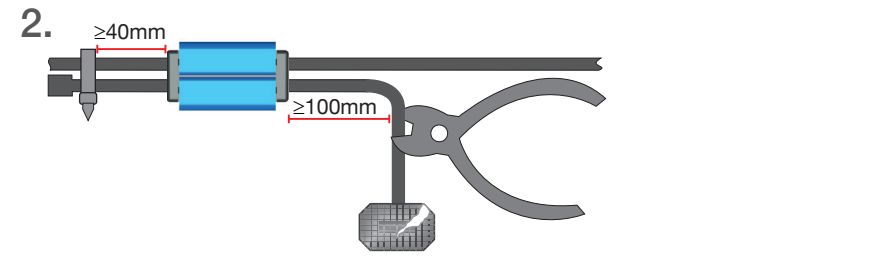
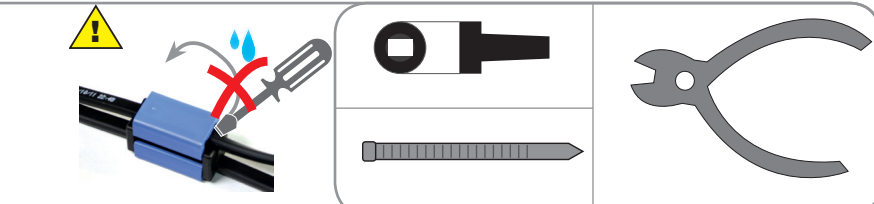

P&R System

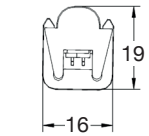
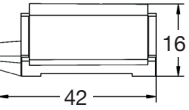

$I_{max}=8A$

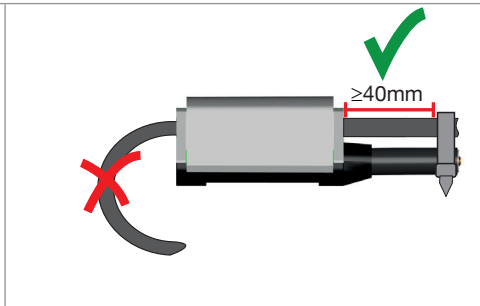
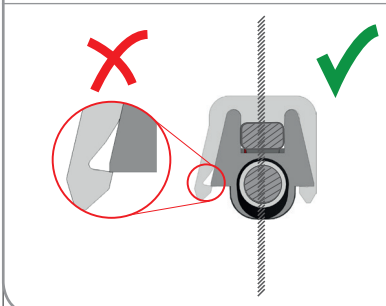
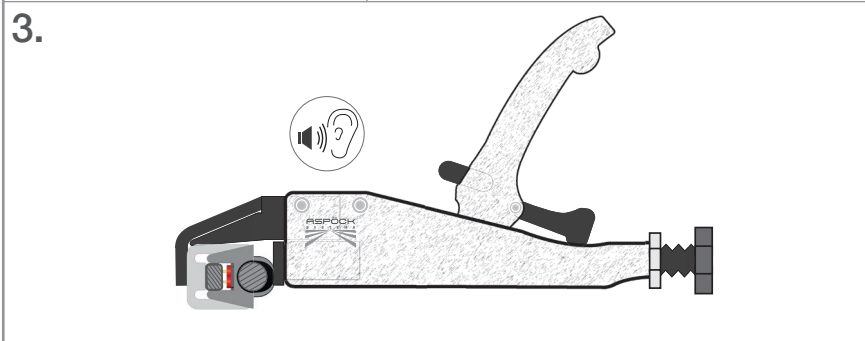
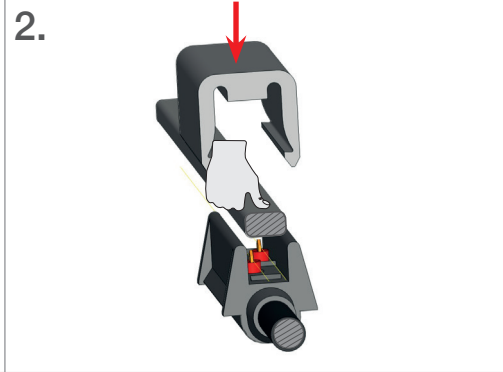
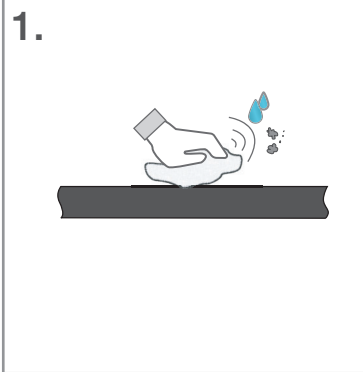
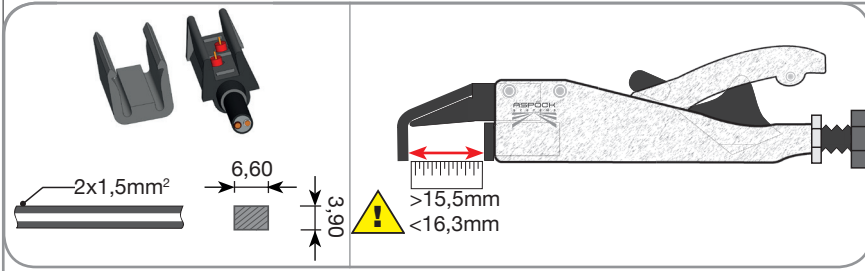
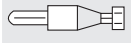

P&R System

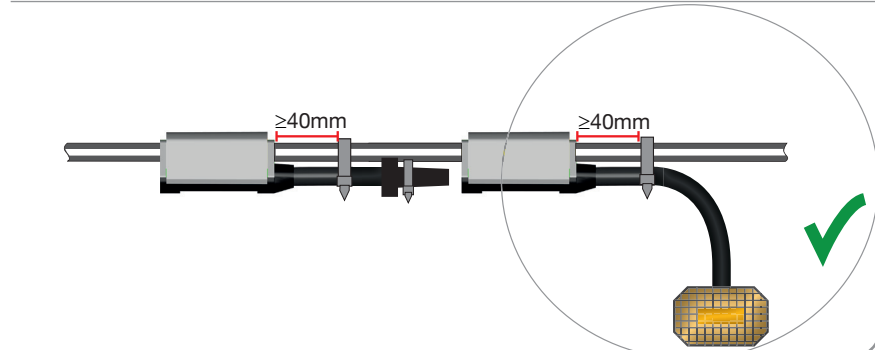
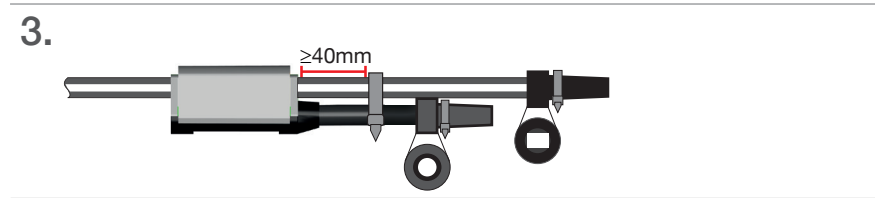
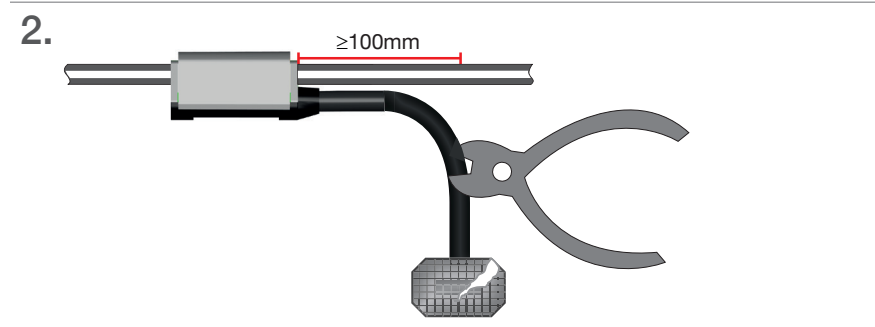
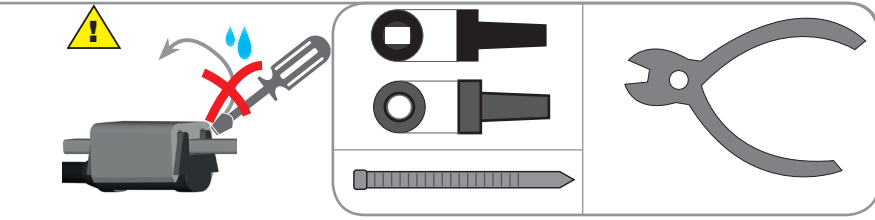

Bayonet
2 pin

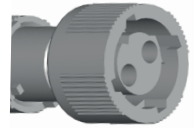

I_{max}=16A

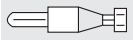

Bayonet 2 pin female

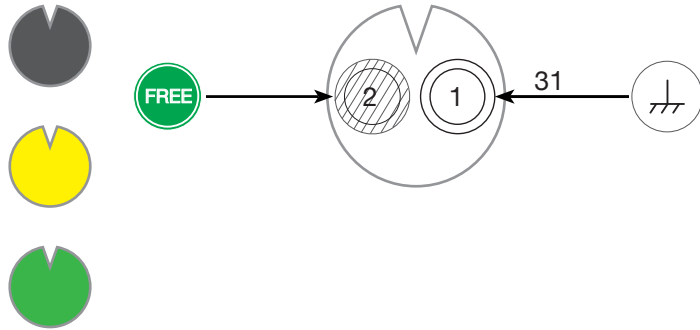

Mounting instruction Bayonet 2 pin female

SPARE PART NO.: 13-0246-004

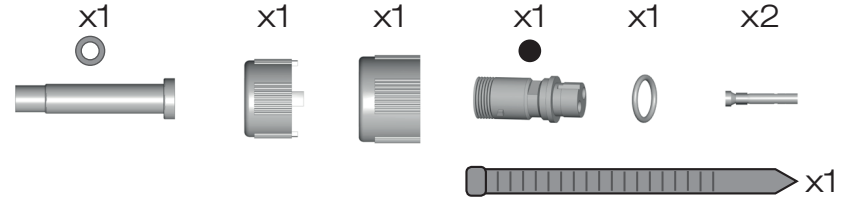

1. Plug the cable into the connector housing.
2. Insert the cap and housing into the connector housing.
3. Insert the pin and nut into the connector housing. A callout shows a 35mm length for the pin and a 5mm length for the nut.
4. Tighten the nut and washer. A warning icon indicates to avoid over-tightening.
5. Tighten the cap and housing. A green checkmark indicates the assembly is complete.

Bayonet
2 pin

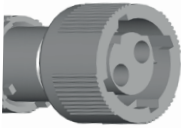

I_{max}=16A



Bayonet
2 pin

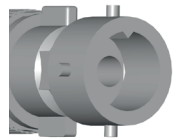

I_{max}=16A

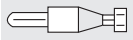

Bayonet 2 pin male

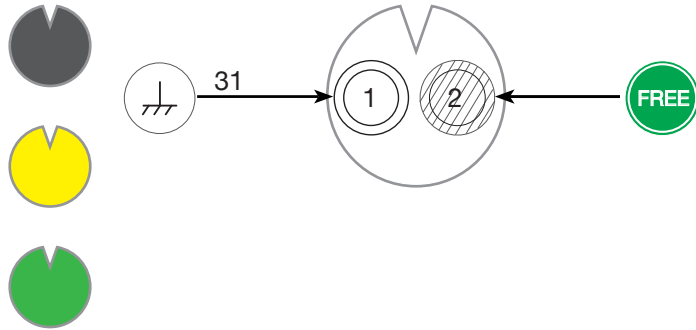
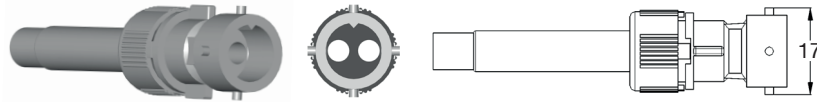

Mounting instruction Bayonet 2 pin male

SPARE PART NO.: 13-0236-004

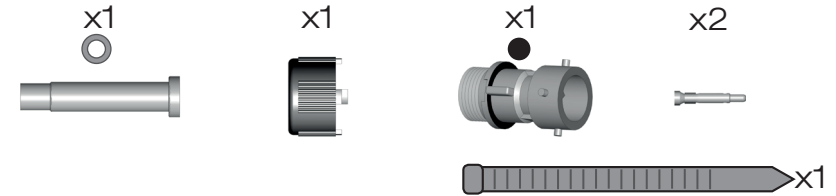

1. Plug the connector into the housing.
2. Insert the pin into the connector.
3. Tighten the connector onto the pin. A callout shows a 35mm length and a 5mm gap.
4. Push the assembly into the housing. An ear icon indicates an audible click.
5. Turn the housing clockwise to lock the connector in place. A green checkmark indicates the final assembly is complete.

Bayonet
2 pin

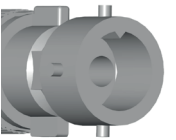

I_{max}=16A

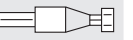

Bayonet 5 pin

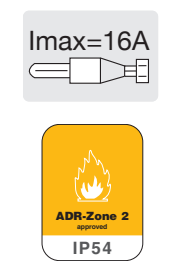
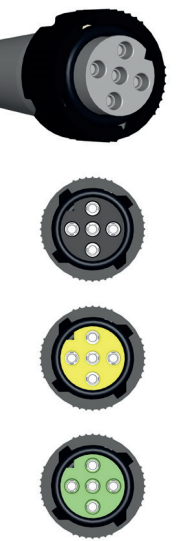

Bayonet 5 pin female

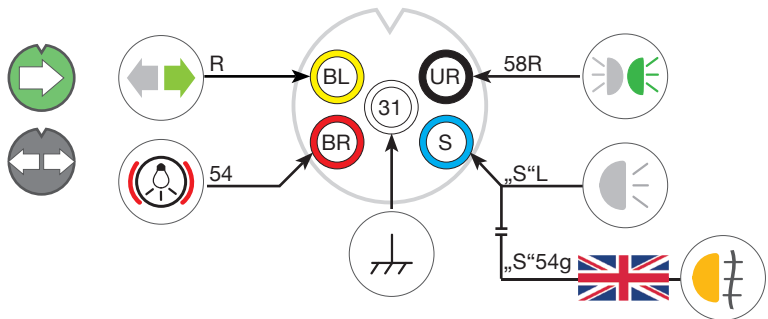
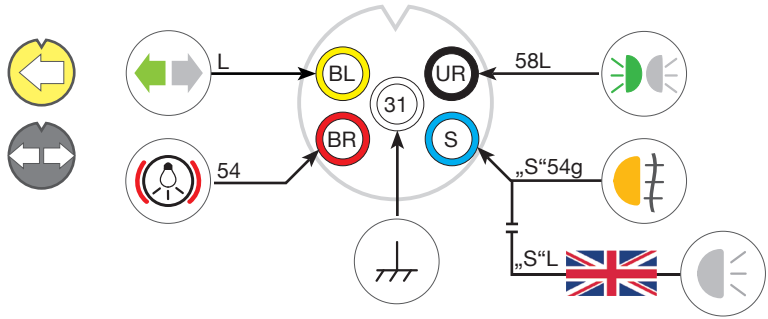
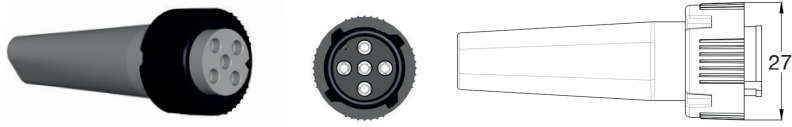

Mounting instruction Bayonet 5 pin female

SPARE PART NO.: 13-0521-104

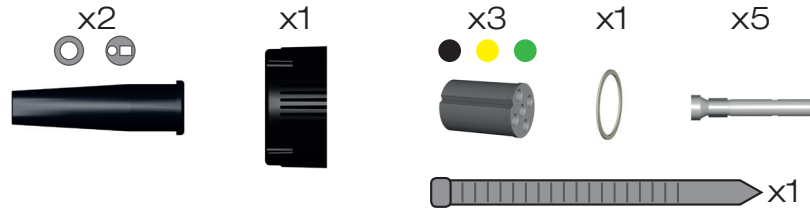

1. Plug the connector into the cable.
2. Insert the O-ring into the connector housing.
3. Insert the pins into the connector housing.
4. Tighten the screws. A close-up shows a 35mm length and a 5mm gap between the housing and the pins.
5. Tighten the long screw. An ear icon indicates an audible click, and a green checkmark indicates successful completion.

Bayonet 5 pin

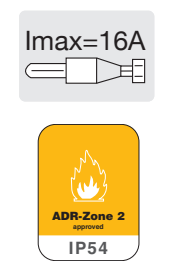

Bayonet
5 pin



Bayonet 5 pin male

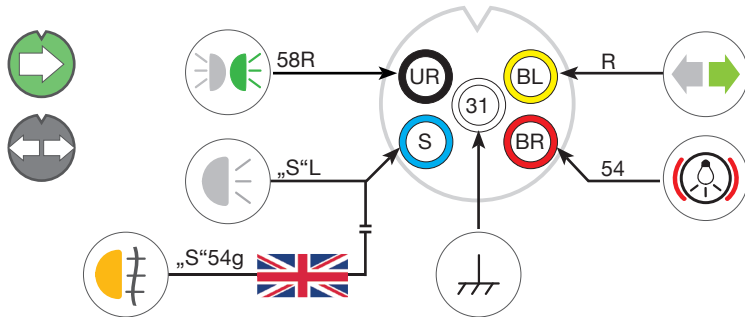
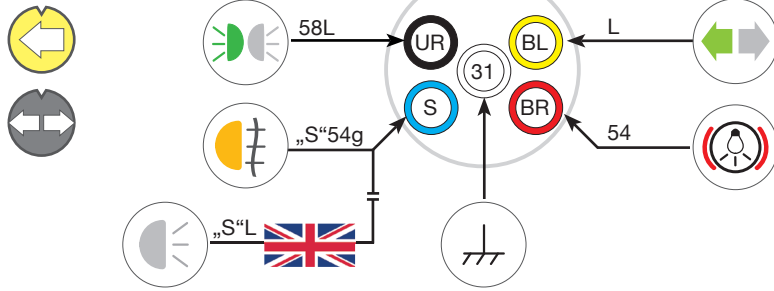
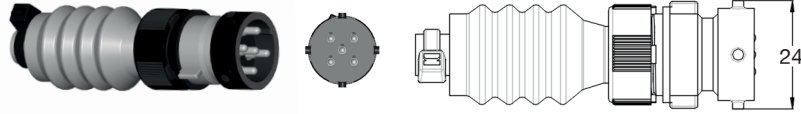

Imax=16A



Mounting instruction Bayonet 5 pin male

SPARE PART NO.: 13-0536-044

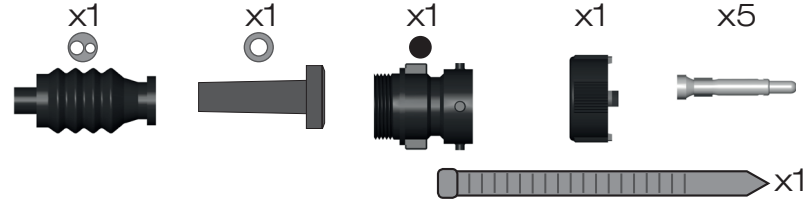

1. Insert the contact pin into the housing.
2. Slide the contact sleeve onto the contact pin.
3. Push the contact nut onto the contact sleeve. A callout shows a 35mm length and a 5mm gap.
4. Tighten the contact nut. A warning icon indicates to avoid over-tightening.
5. Tighten the mounting screw. A green checkmark indicates the final assembly is complete.

Bayonet
5 pin

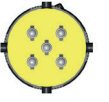
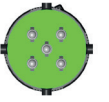
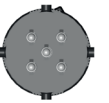
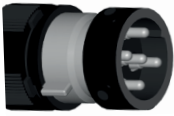

Imax=16A



Bayonet
8 pin

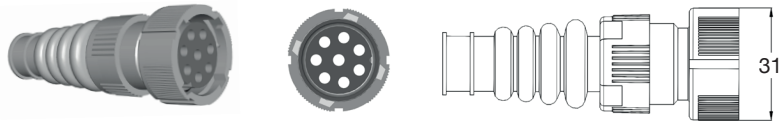
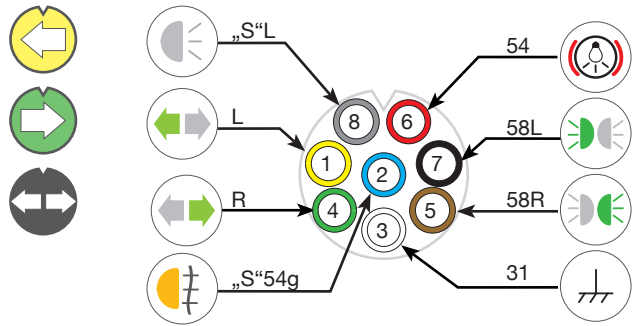
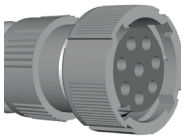

I_{max}=16A



Bayonet 8 pin female

Mounting instruction Bayonet 8 pin female

SPARE PART NO.: 13-0828-034

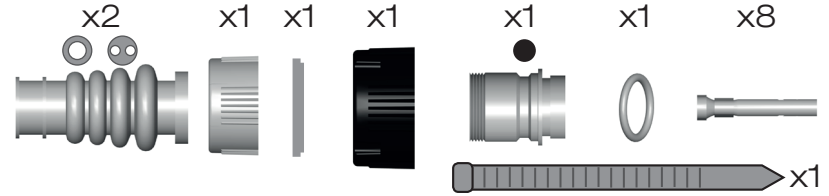

Bayonet
8 pin

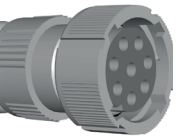

1. Insert the bayonet sleeve into the connector housing.
2. Push the bayonet nut onto the bayonet sleeve.
3. Push the bayonet sleeve into the bayonet nut.
4. Push the bayonet sleeve into the bayonet nut until it is fully seated.
5. Push the bayonet pins into the bayonet sleeve. A dimension line indicates a length of 35mm for the pins and 5mm for the sleeve.
6. Push the bayonet sleeve into the bayonet nut until it is fully seated. A green checkmark indicates the final assembly is complete.

I_{max}=16A



Bayonet 8 pin

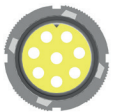
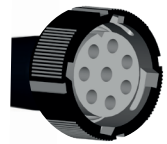

Imax=16A



Bayonet 8 pin female

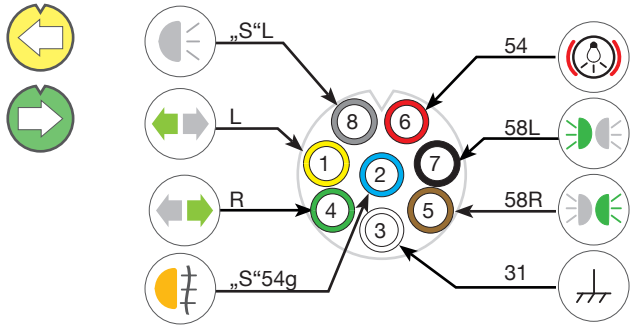
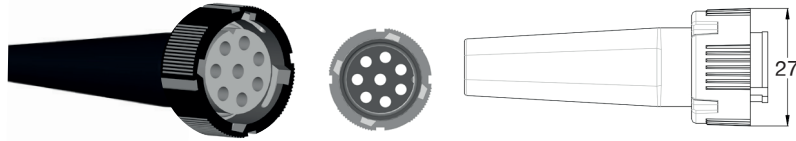

Mounting instruction Bayonet 8 pin female

SPARE PART NO.: 15-0821-524

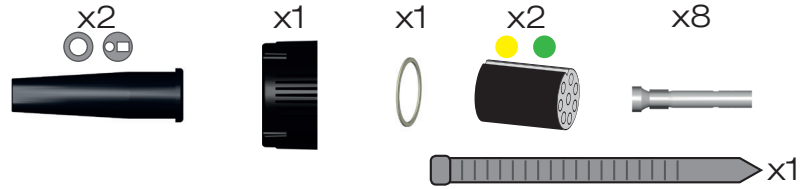

1. Insert the cable into the connector housing.
2. Push the washer into the housing to secure the cable.
3. Insert the nut into the housing.
4. Tighten the nut. A warning icon indicates a maximum tightening torque of 35mm (5mm) for the nut.
5. Tighten the pins. A warning icon indicates a maximum tightening torque of 35mm (5mm) for the pins. A green checkmark indicates the final assembly is complete.

Bayonet 8 pin

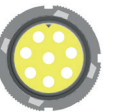
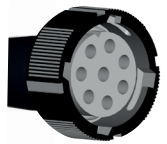

Imax=16A



Bayonet
8 pin

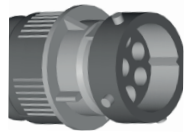

I_{max}=16A



Bayonet 8 pin male

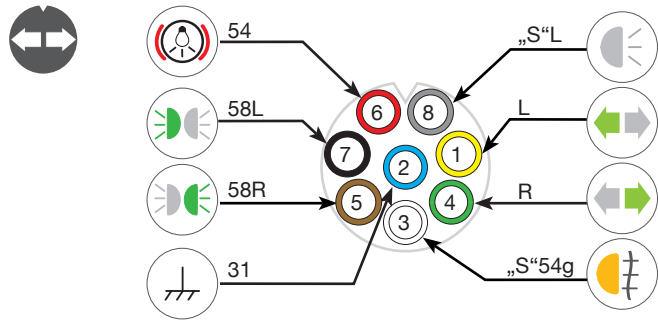
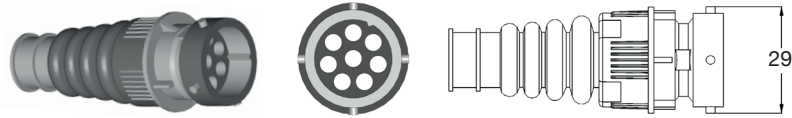

Mounting instruction Bayonet 8 pin male

SPARE PART NO.: 13-0838-054

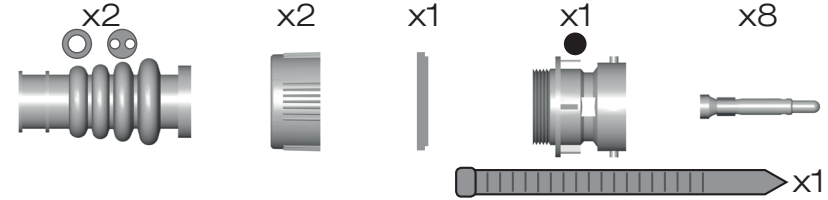

1. Insert the plug into the housing.
2. Push the housing onto the plug.
3. Tighten the nut on the plug. A callout shows a 35mm length and a 5mm gap.
4. Tighten the nut on the housing. A warning icon indicates to avoid over-tightening.
5. Final assembly check with a green checkmark.

Bayonet
8 pin

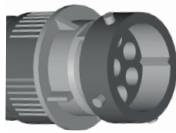

I_{max}=16A



Bayonet 15 pin female

Bayonet 15 pin

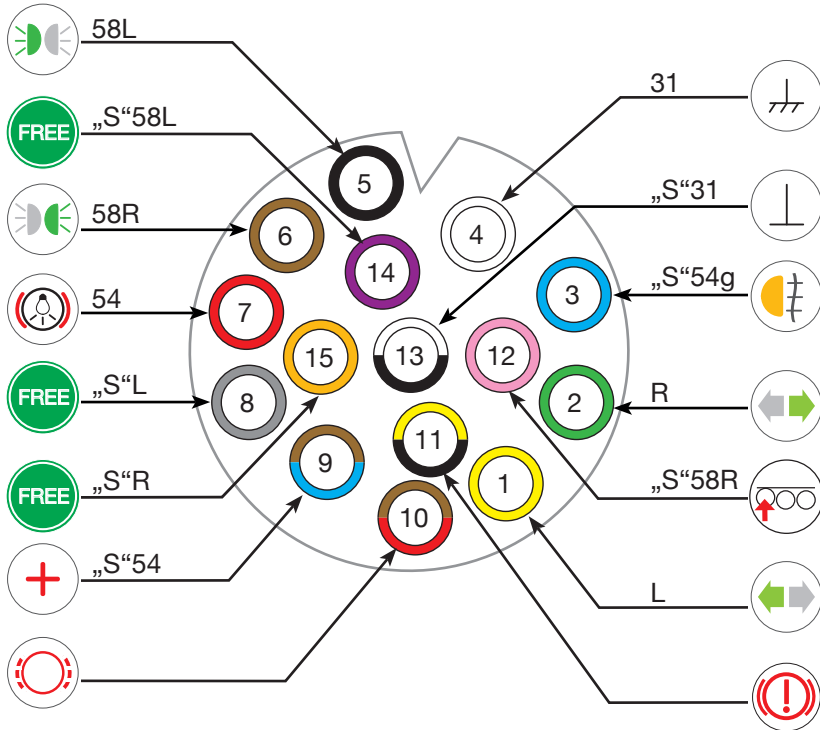
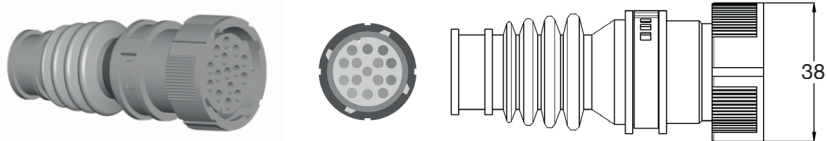

Imax=16A



Mounting instruction Bayonet 15 pin female

SPARE PART NO.: 13-1540-004

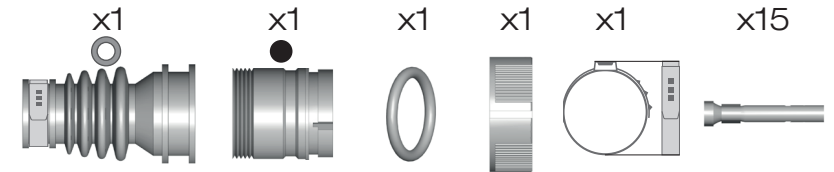

1. Insert the plug into the socket.
2. Assemble the housing, O-ring, and locking rings.
3. Insert the pins into the housing. A 35mm dimension is shown for the pin length, and a 5mm dimension is shown for the pin protrusion.
4. Check the connection. A warning symbol (ear with a question mark) is shown next to the plug.
5. Tighten the locking ring with a screwdriver. A green checkmark indicates the final assembly is complete.

Bayonet 15 pin

Imax=16A



Bayonet
15 pin

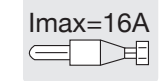
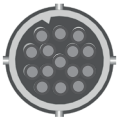
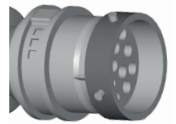

Bayonet 15 pin male

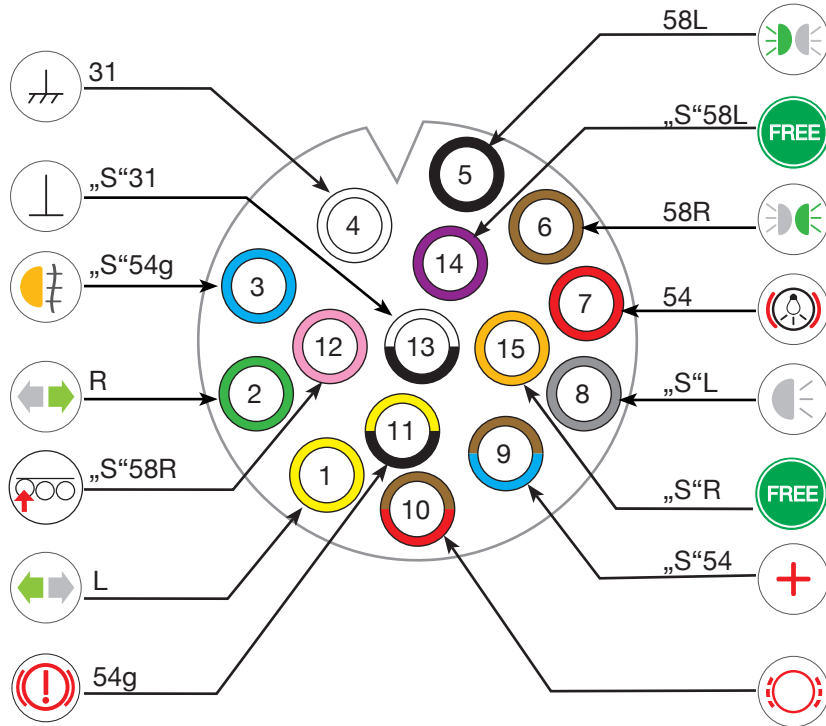

Mounting instruction Bayonet 15 pin male

SPARE PART NO.: 13-1530-004

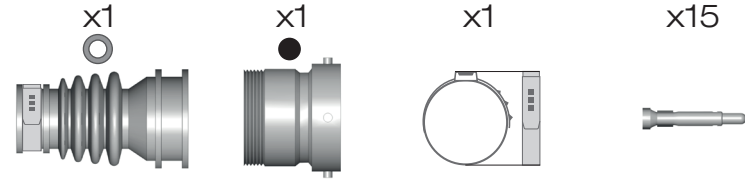

1. Plug the cable into the housing.
2. Push the housing onto the contact ring.
3. Push the contact ring onto the cable pins. A 35mm length of the cable jacket is shown being pushed back 5mm.
4. Push the contact ring onto the cable pins until it is fully seated.
5. Tighten the housing with a screwdriver to secure the connection.

Bayonet
15 pin

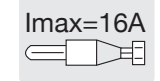
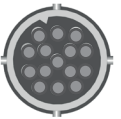
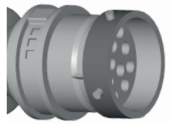

ASS1, ASS2 2 pin female

Mounting instruction ASS1, ASS2 2 pin female

ASS1,
ASS2
2 pin

ASS1,
ASS2
2 pin

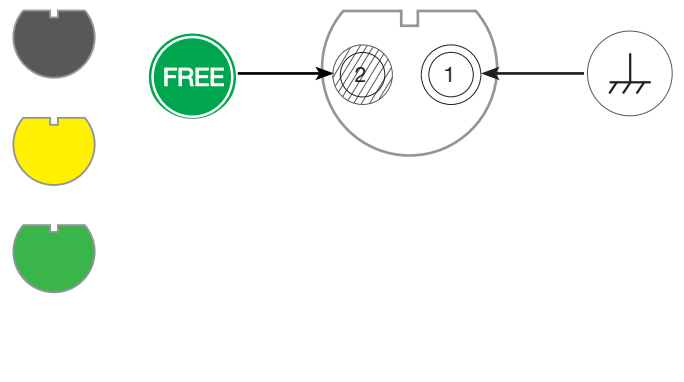
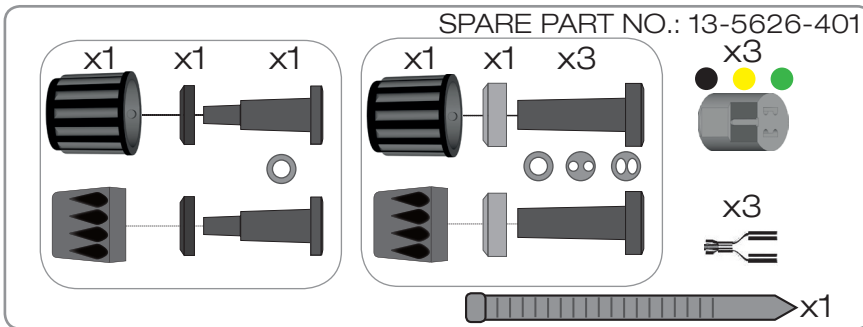
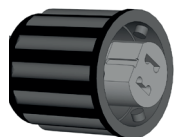

1. Insert the plug into the socket.
2. Push the plug into the socket until it is fully seated.
3. Push the plug into the socket until it is fully seated.
4. Push the plug into the socket until it is fully seated.
5. Push the plug into the socket until it is fully seated.

Imax=25A

ASS 1 ASS 2



Imax=25A



ASS1, ASS2 2 pin male

Mounting instruction ASS1, ASS2 2 pin male

ASS1,
ASS2
2 pin

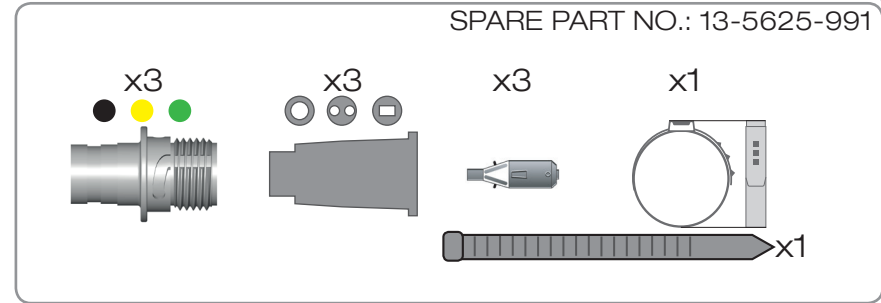
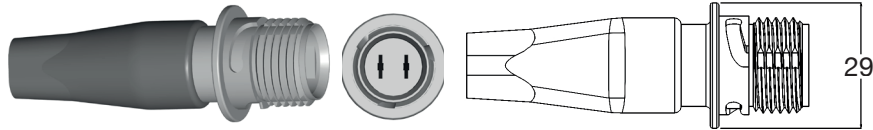
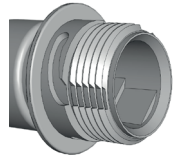

ASS1,
ASS2
2 pin

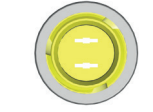
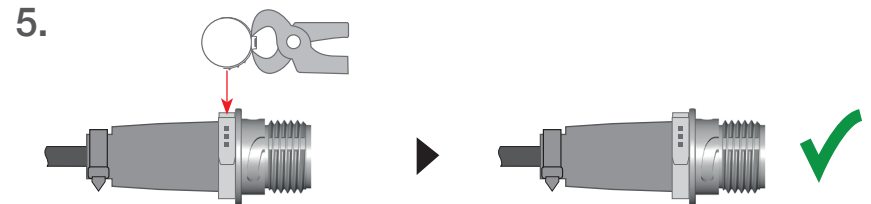
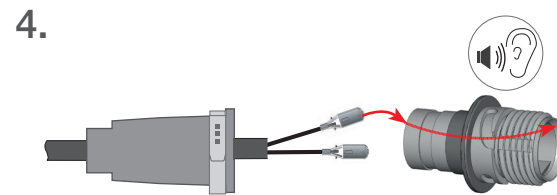
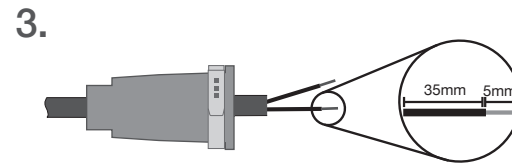
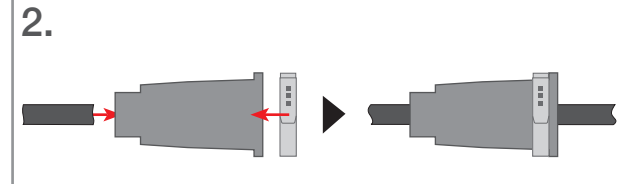
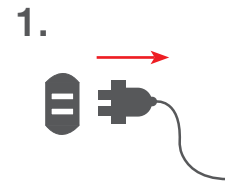
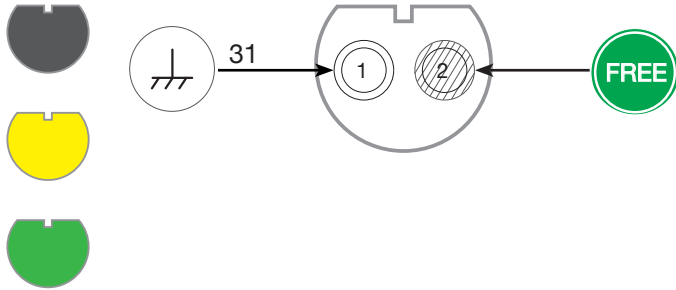
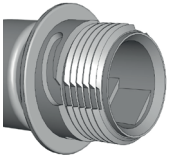

Imax=25A

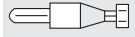

ASS 1

ASS 2



IP68



IP68K9K

Imax=25A

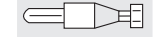

IP68

ASS1,
ASS2,
ASS2.1,
7 pin

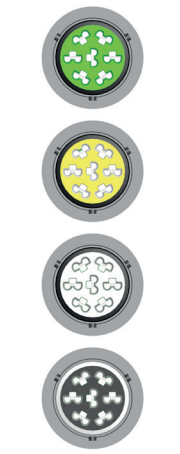

Imax=25A



ASS 1 ASS 2,2.1



ASS1, ASS2, ASS2.1 7 pin female

Mounting instruction ASS1, ASS2 7 pin female

ASS1,
ASS2,
ASS2.1,
7 pin

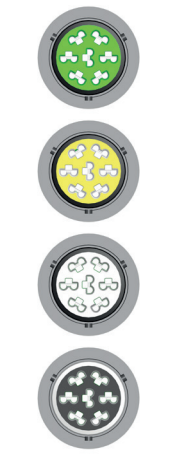

Imax=25A

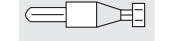

ASS 1 ASS 2,2.1

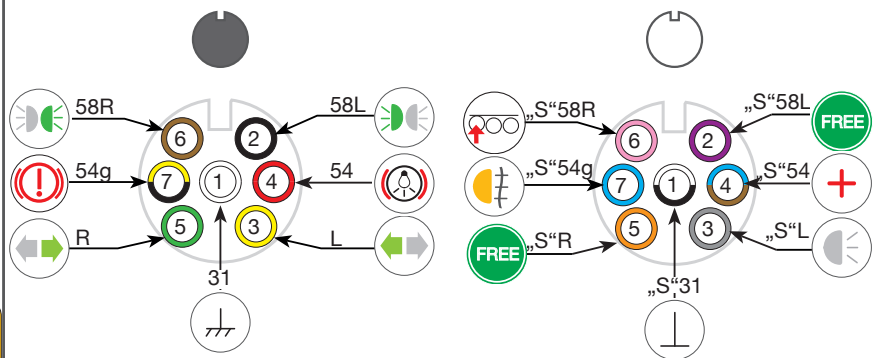
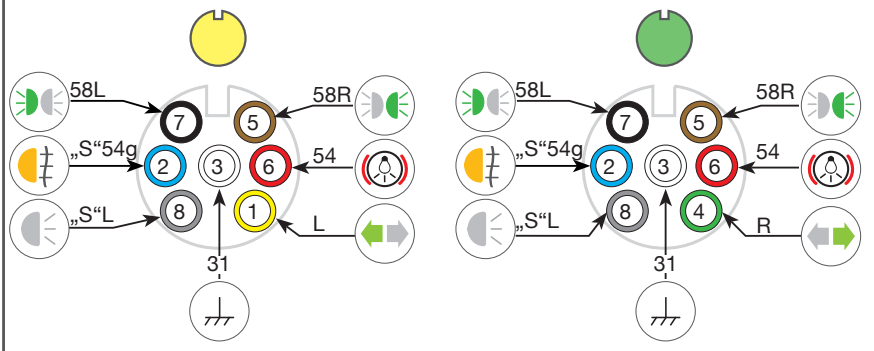
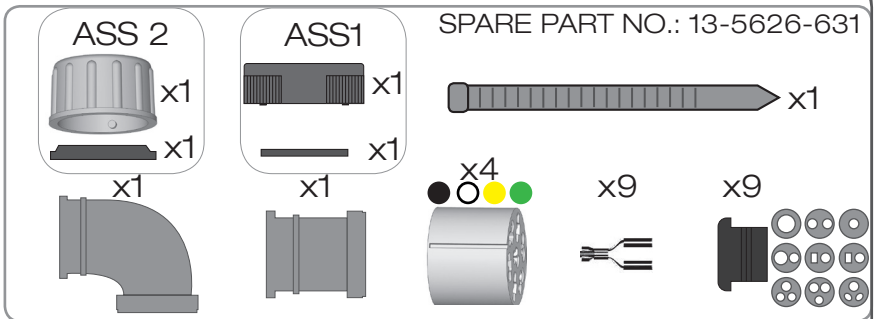

1. Insert the plug into the housing.
2. Push the sleeve onto the plug.
3. Push the housing onto the sleeve.
4. Push the cap onto the housing. A 35mm diameter area is shown around the cap, and a 5mm gap is indicated between the cap and the housing.
5. Push the long pin into the cap. A sound icon is shown next to the pin.



ASS1,
ASS2,
ASS2.1,
7 pin

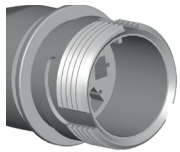

Imax=25A

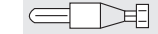

ASS 1 ASS 2,2.1



ASS1, ASS2, ASS2.1 7 pin male

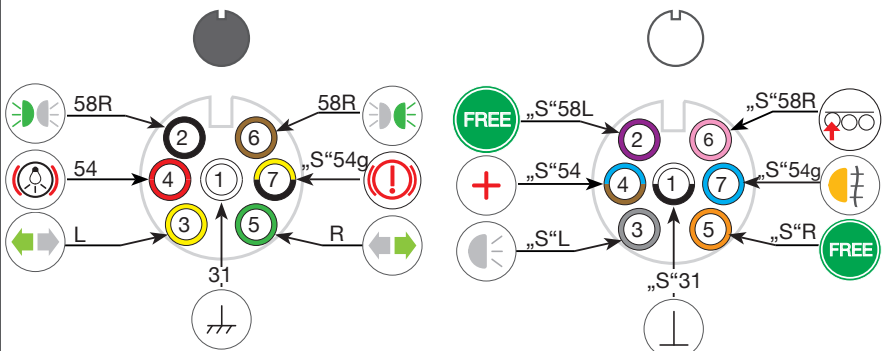
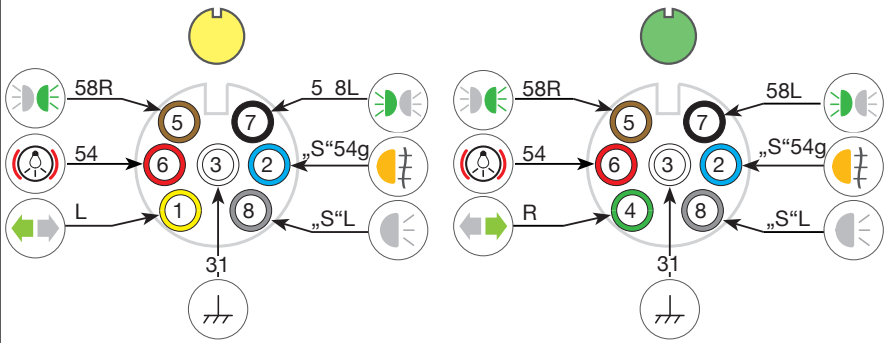

Mounting instruction ASS1, ASS2 7 pin male

SPARE PART NO.: 13-5625-981

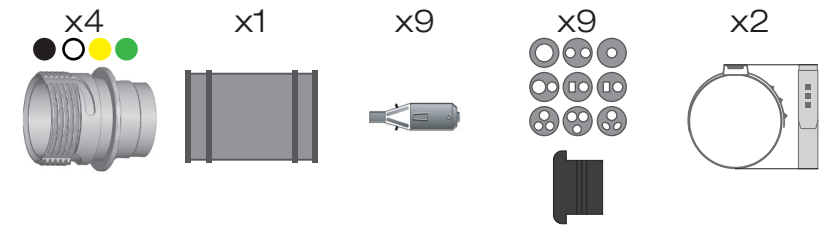

1. Insert the plug into the connector housing.
2. Insert the LED modules into the housing.
3. Insert the pins into the housing.
4. Tighten the housing cap, ensuring a 35mm gap and a 5mm overlap.
5. Tighten the housing cap with a screwdriver.

ASS1,
ASS2,
ASS2.1,
7 pin

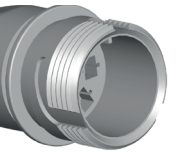

Imax=25A



ASS3 3 pin female

ASS3
3 pin

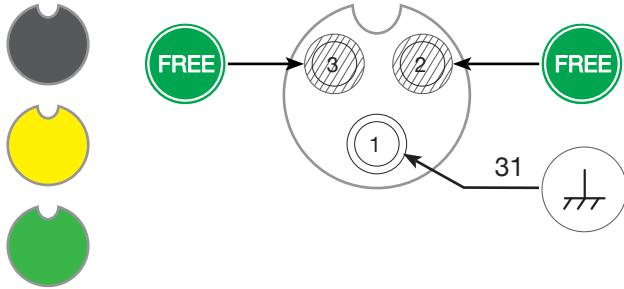

I_{max}=16A



Mounting instruction ASS3 3 pin female

SPARE PART NO.: 13-0322-281

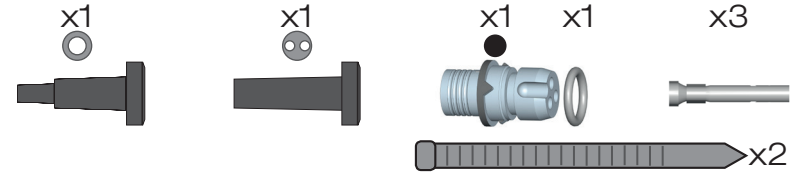

1. Plug the cable into the connector.
2. Push the cap onto the connector.
3. Insert the plug into the connector.
4. Tighten the screws. A callout shows a 35mm length for the main screw and a 5mm length for the shorter screw.
5. Tighten the screws. A warning icon (ear with a question mark) is shown, indicating a warning about noise or vibration. The final assembly is shown with a green checkmark.

ASS3
3 pin

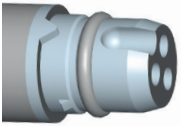

I_{max}=16A

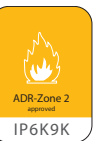

ASS3 3 pin male

ASS3
3 pin

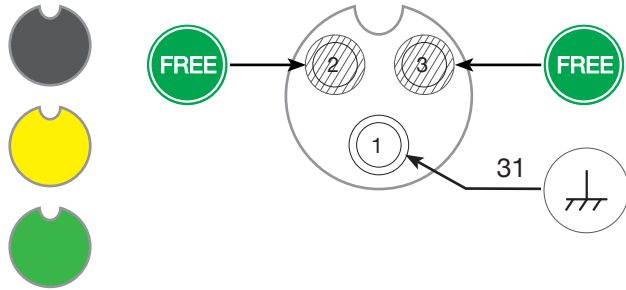

I_{max}=16A



Mounting instruction ASS3 3 pin male

SPARE PART NO.: 13-0332-281

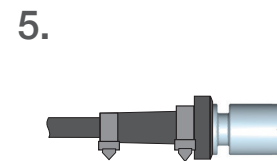
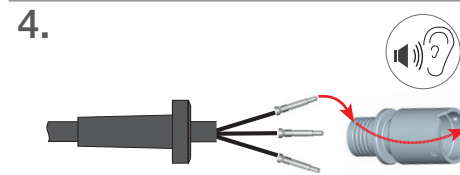
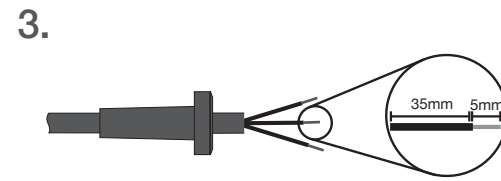
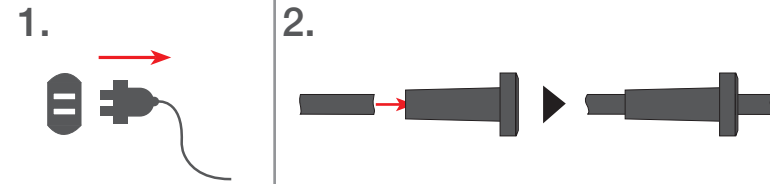
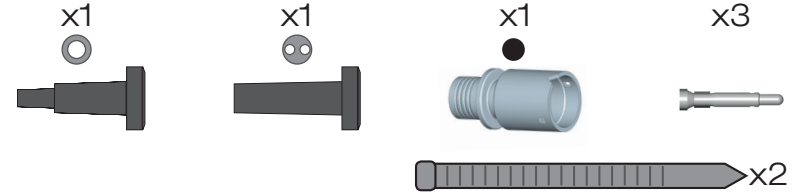

ASS3
3 pin

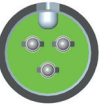
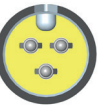
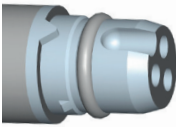

I_{max}=16A



ASS3 17 pin female

ASS3
17 pin

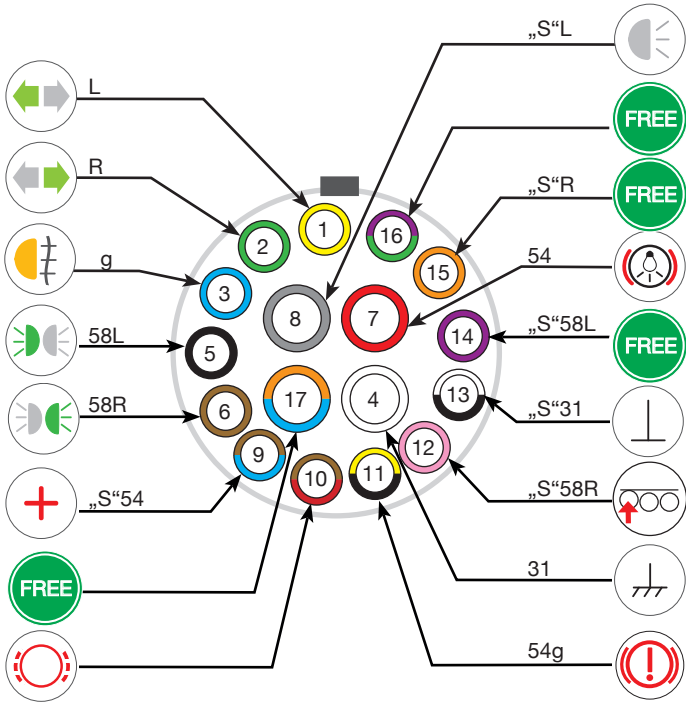
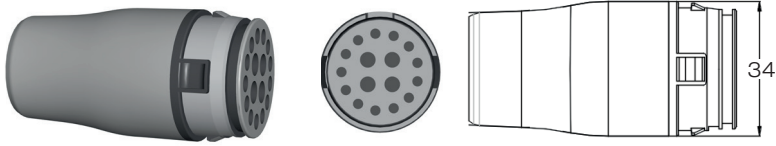

Imax=16A



Mounting instruction ASS3 17 pin female

SPARE PART NO.: 13-1722-001

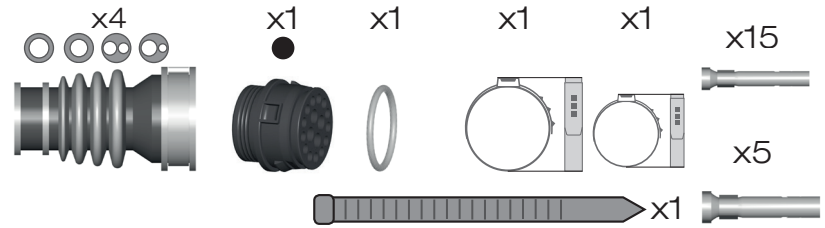

1. Insert the plug into the connector housing.
2. Push the housing onto the plug until it is fully seated.
3. Push the housing onto the plug until the pins are fully inserted. A 35mm x 5mm dimension is shown for the housing length.
4. Tighten the nut and washer onto the housing to secure the plug.
5. Use a screwdriver to tighten the screws, ensuring the housing is fully secured.

ASS3
17 pin

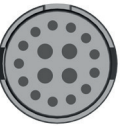

Imax=16A

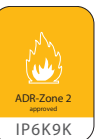

ASS3 17 pin male

ASS3
17 pin

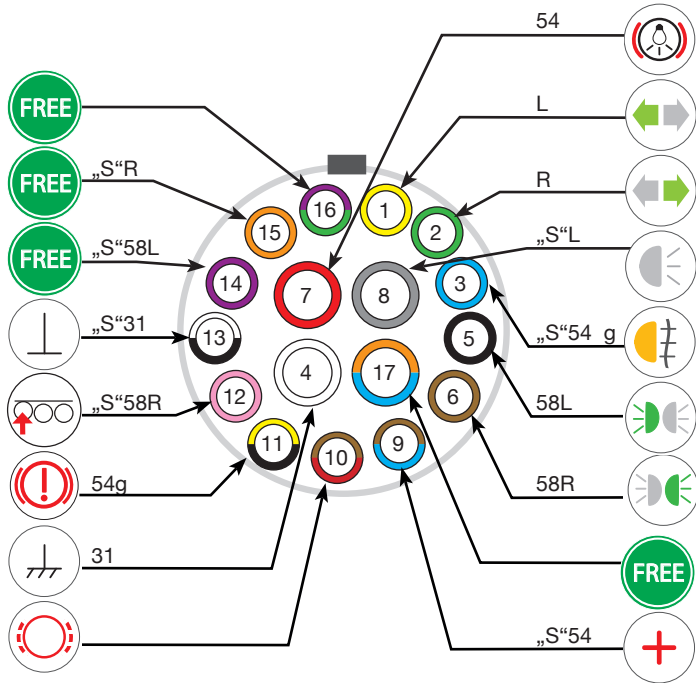
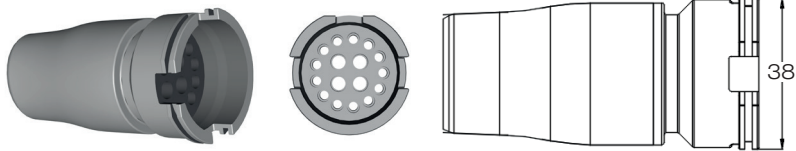

Imax=16A

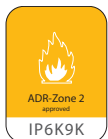

Mounting instruction ASS3 17 pin male

ASS3
17 pin

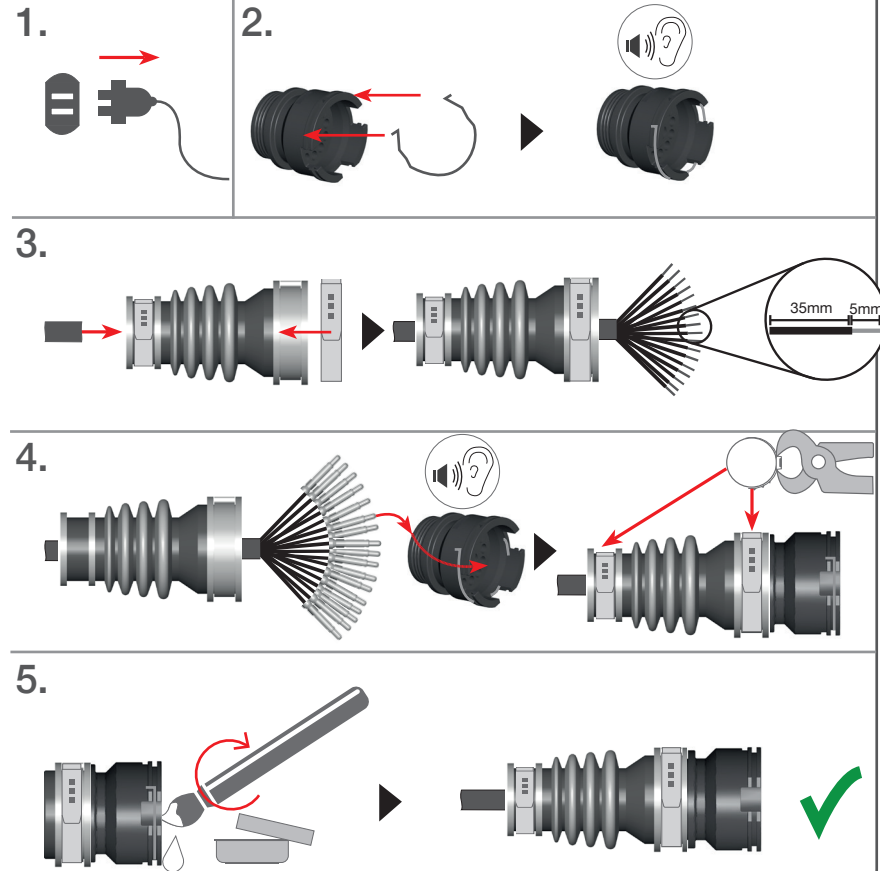
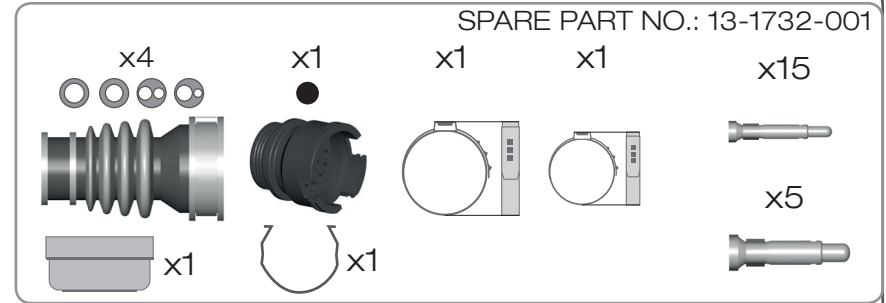

Imax=16A



AMP 4 pin female

Mounting instruction AMP 4 pin female

AMP
4 pin

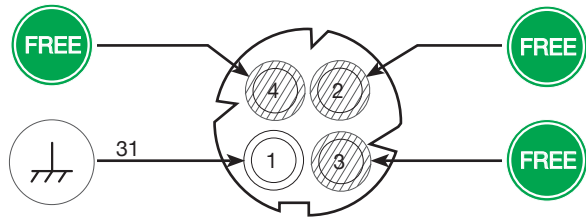

$I_{max}=40A$



SPARE PART NO.: 15-7002-004

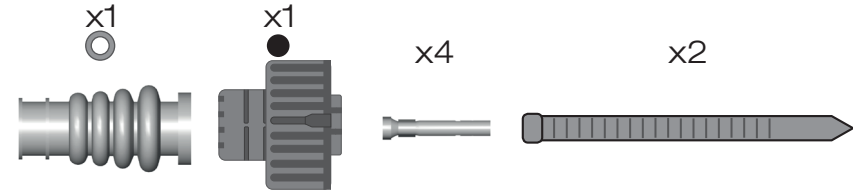

AMP
4 pin



$I_{max}=40A$



- 1.
- 2.
- 3.
- 4.
- 5.

AMP 4 pin male

Mounting instruction AMP 4 pin male

AMP
4 pin



SPARE PART NO.: 15-7002-014

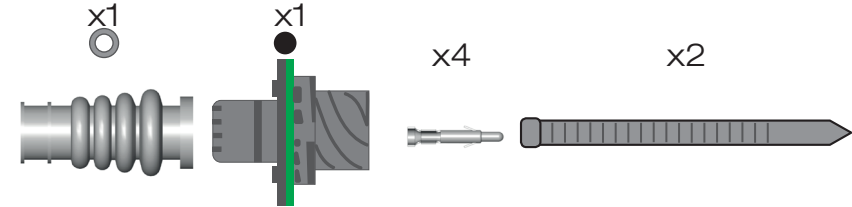

AMP
4 pin

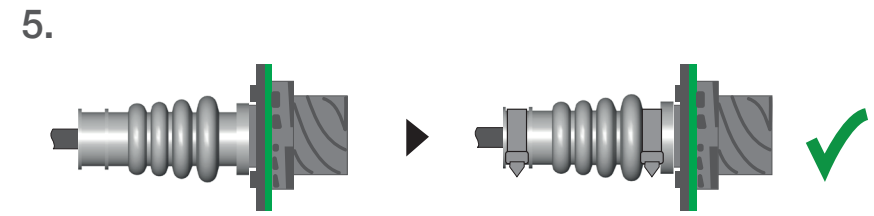
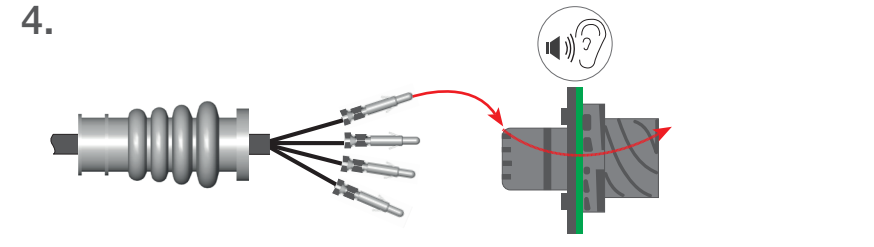
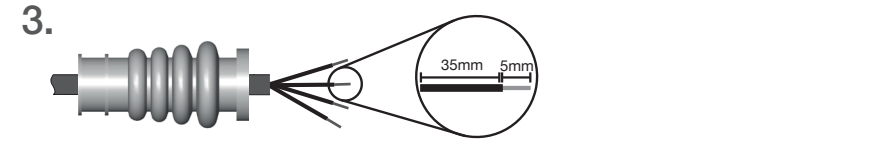
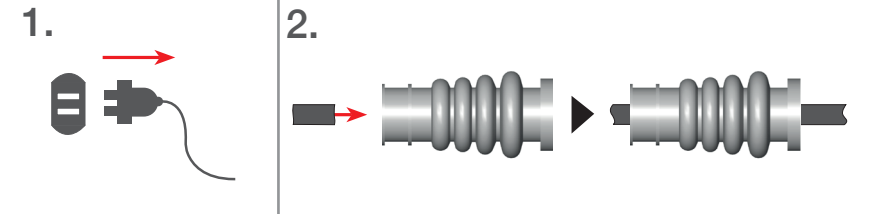
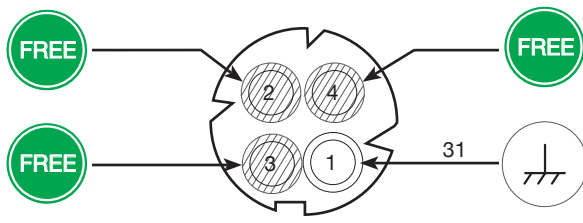

I_{max}=40A

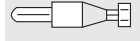

I_{max}=40A

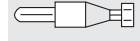

AMP 7 pin female

Mounting instruction AMP 7 pin female

AMP
7 pin

AMP
7 pin

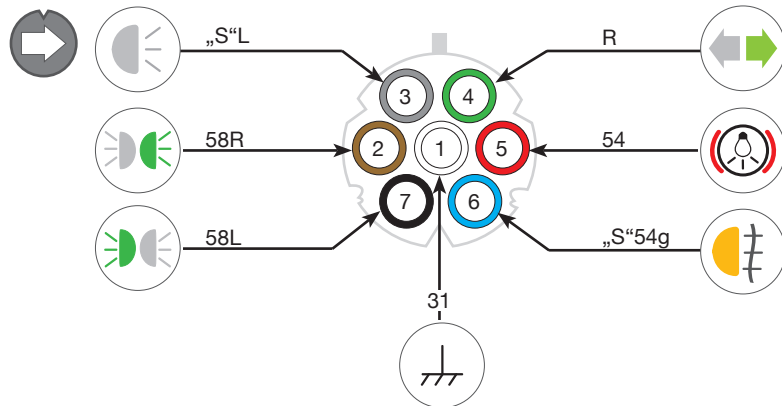
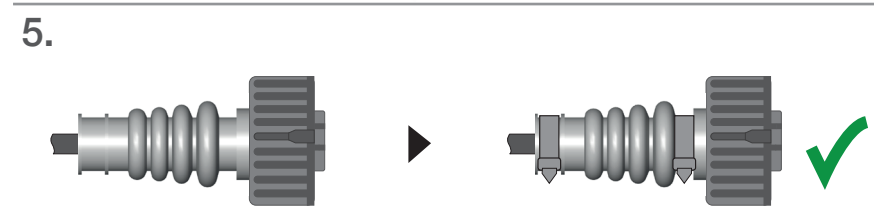
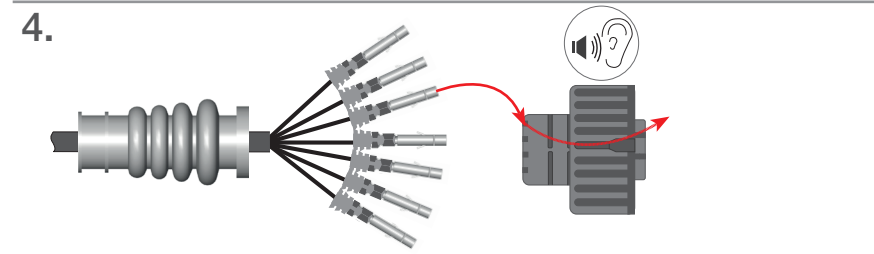
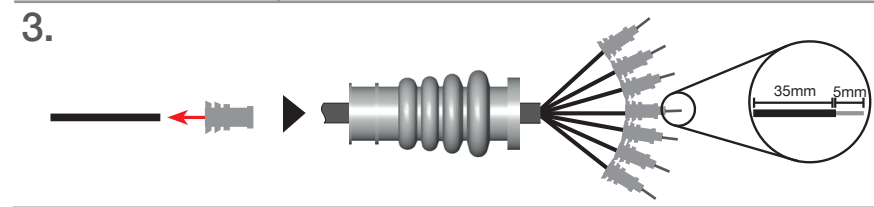
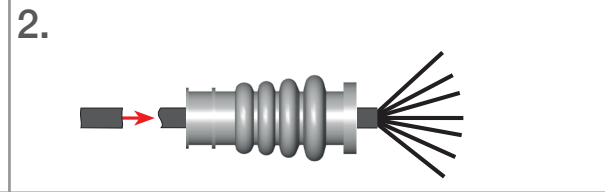
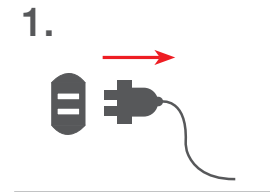
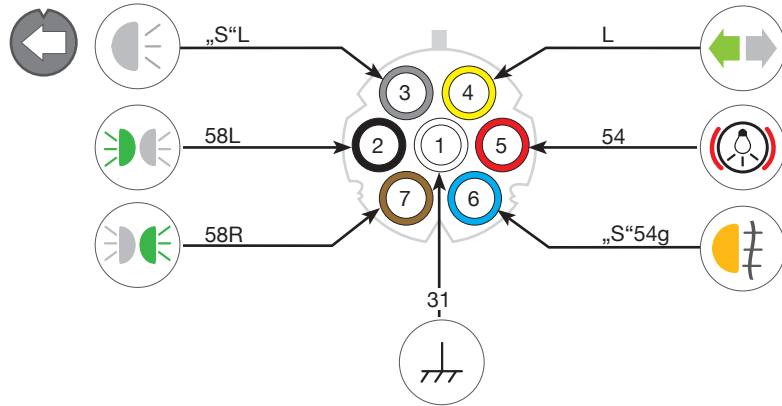
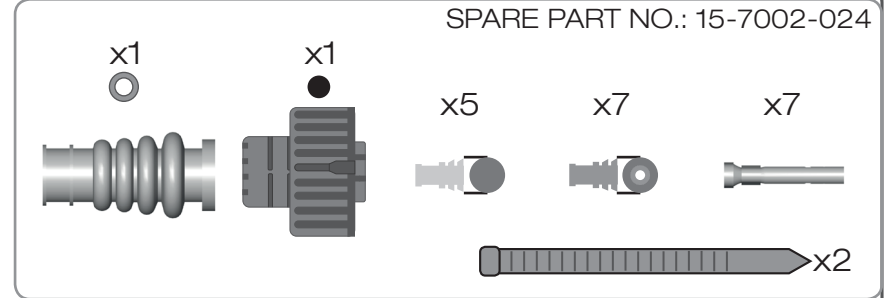

I_{max}=30A

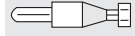

I_{max}=30A



AMP 7 pin male

Mounting instruction AMP 7 pin male

AMP
7 pin

AMP
7 pin

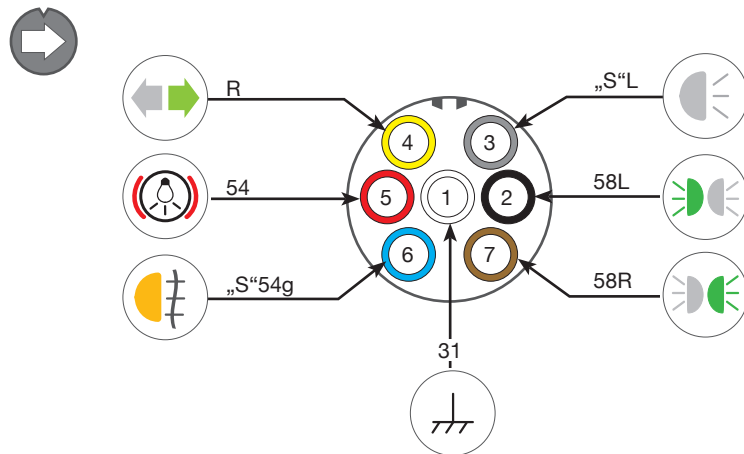
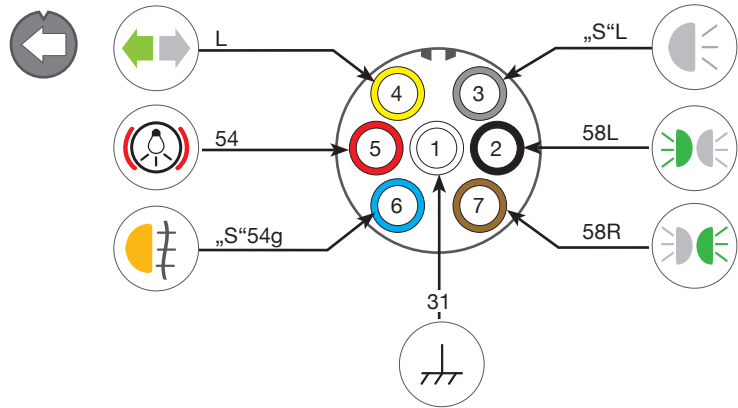
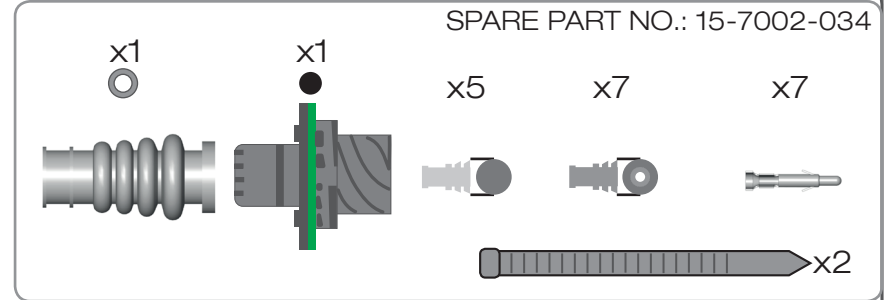

1. Plug the O-ring into the connector housing.
2. Insert the nut into the connector housing.
3. Insert the pins into the connector housing. A 35mm dimension is shown for the pin length, and a 5mm dimension is shown for the pin protrusion.
4. Tighten the nut to secure the pins. A warning icon indicates to avoid over-tightening.
5. Final assembly check showing the connector fully assembled with a green checkmark.

I_{max}=30A

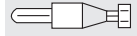

I_{max}=30A



SuperSeal
2 pin

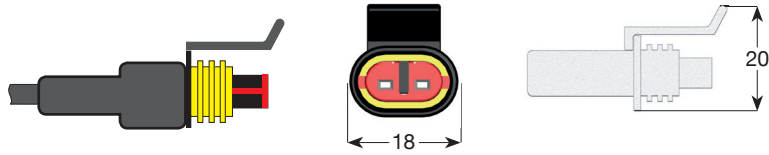

SPARE PART NO.: 15-7002-044

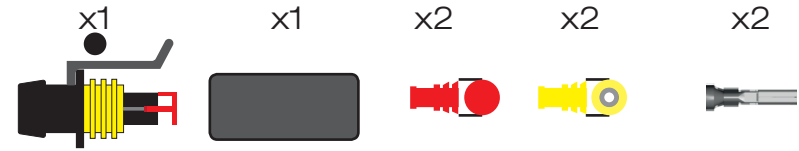

SuperSeal
2 pin

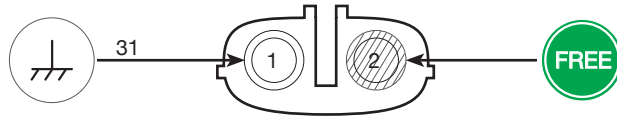

1.

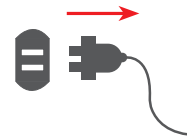

2.

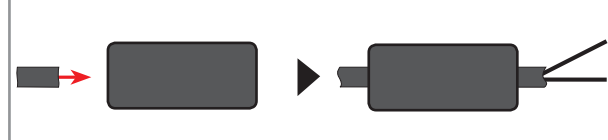

3.

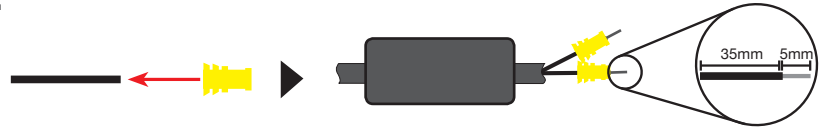

4.

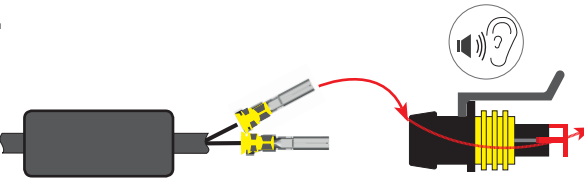

5.

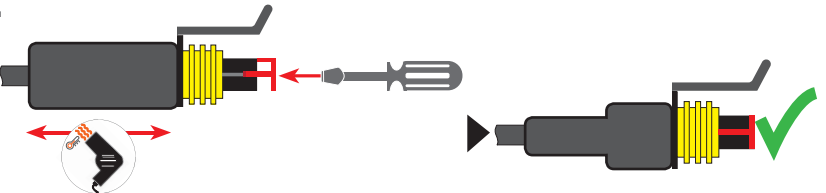

I_{max}=16A



I_{max}=16A



SuperSeal
2 pin

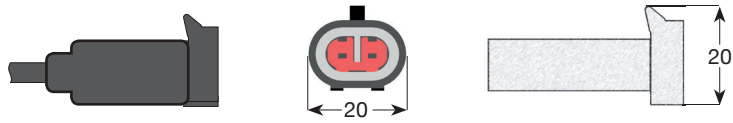

SPARE PART NO.: 15-7002-054

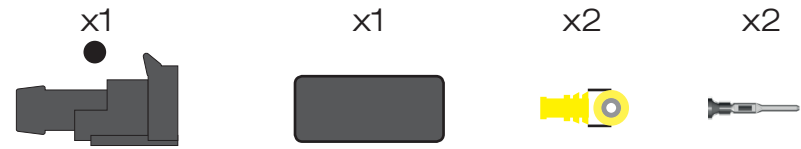

SuperSeal
2 pin

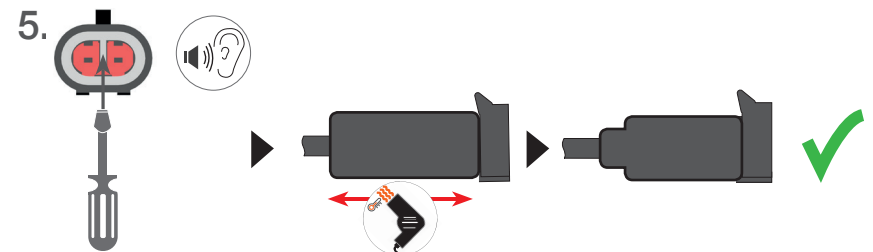
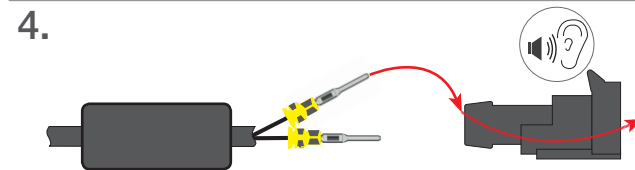
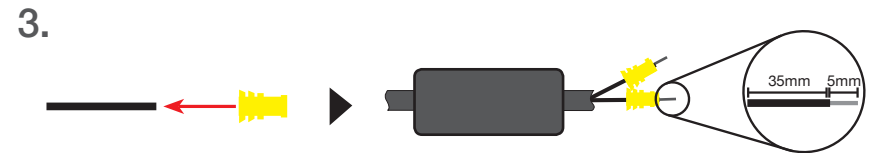
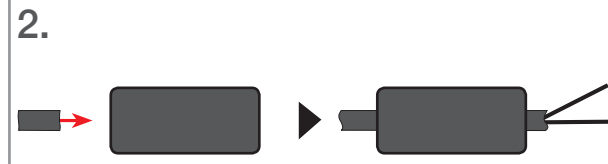
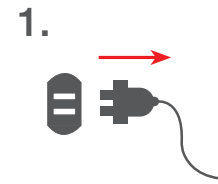
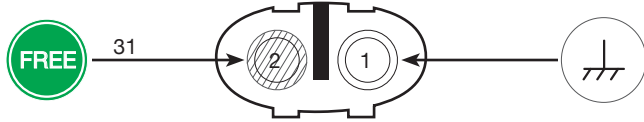

I_{max}=16A



I_{max}=16A



SuperSeal
3 pin

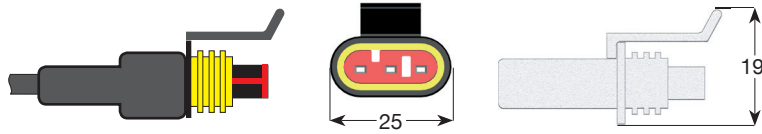

SPARE PART NO.: 15-7002-064

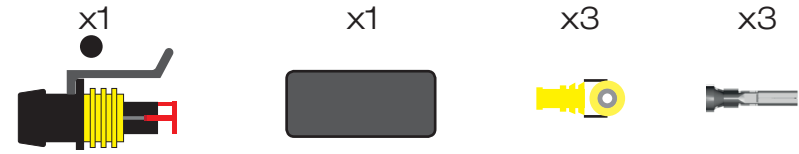

SuperSeal
3 pin

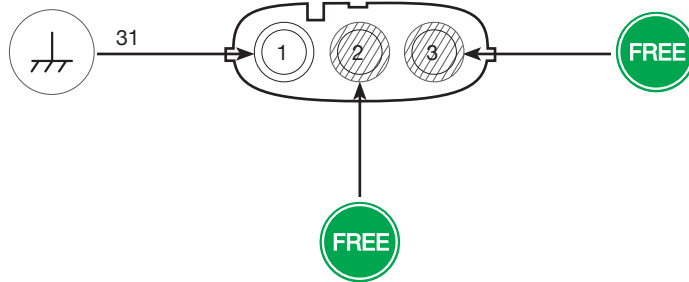

- 1.
- 2.
- 3.
- 4.
- 5.

Imax=16A



Imax=16A



SuperSeal
3 pin

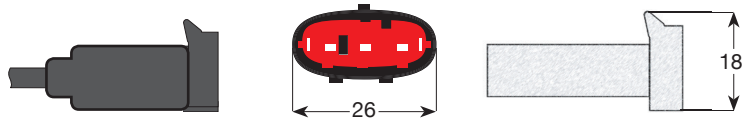

SPARE PART NO.: 15-7002-074

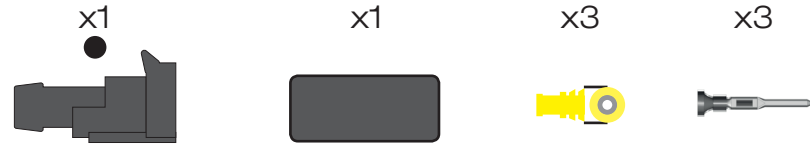

SuperSeal
3 pin

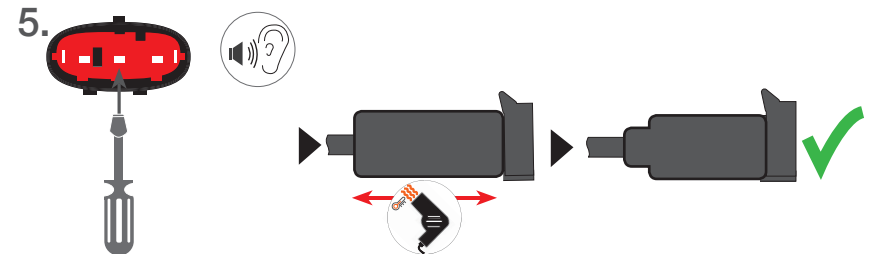
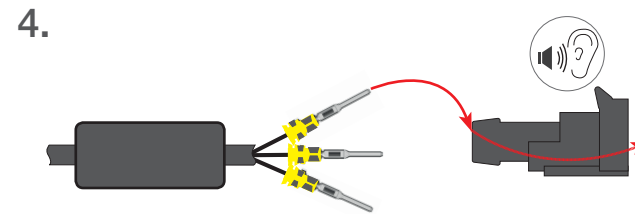
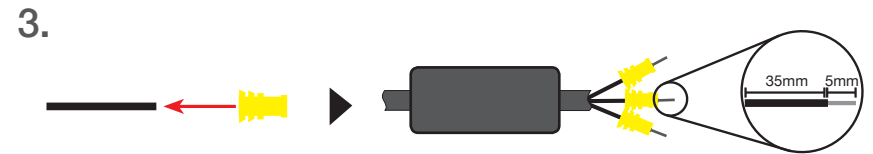
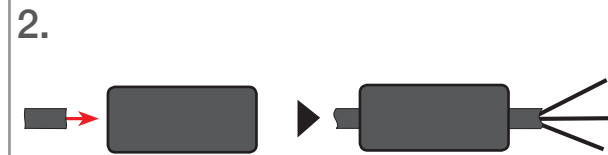
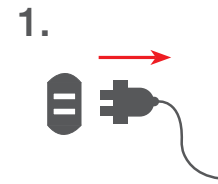
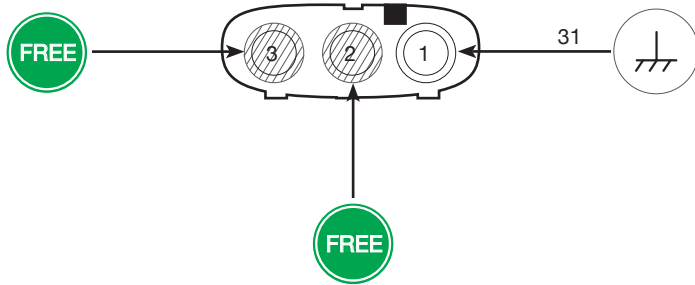

I_{max}=16A



I_{max}=16A

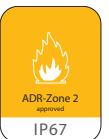

SuperSeal
4 pin

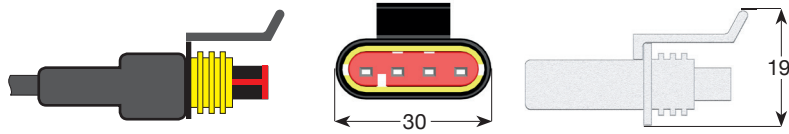

SPARE PART NO.: 15-7002-084

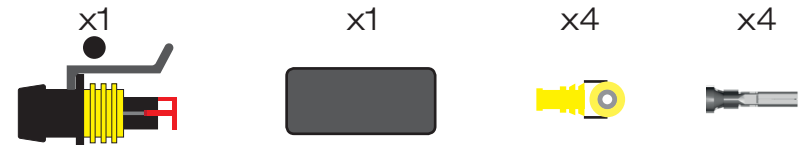

SuperSeal
4 pin

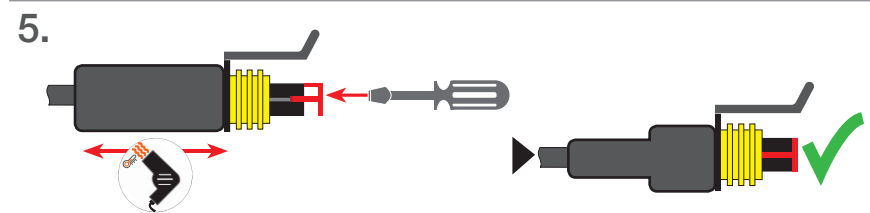
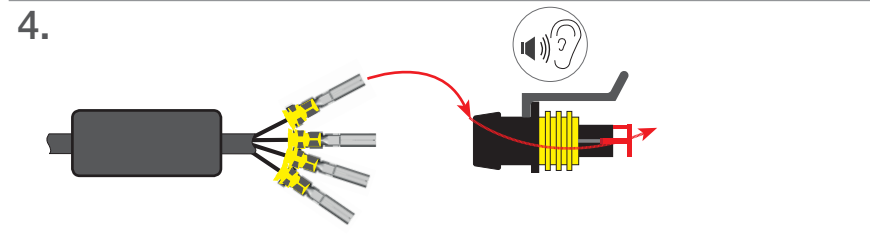
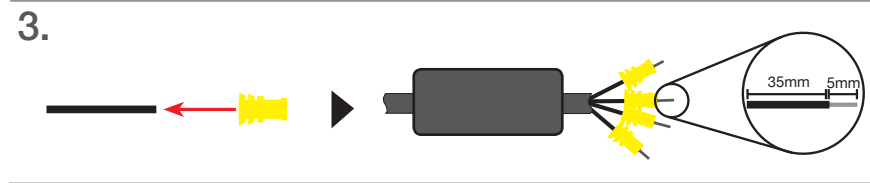
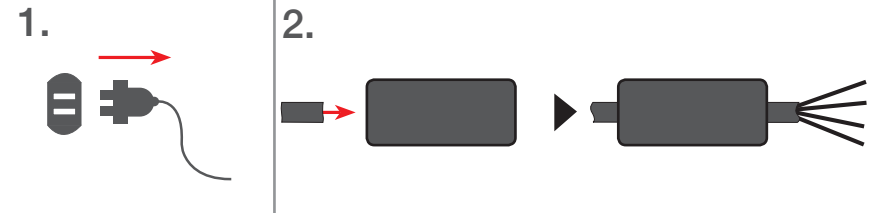
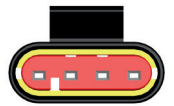
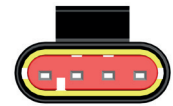
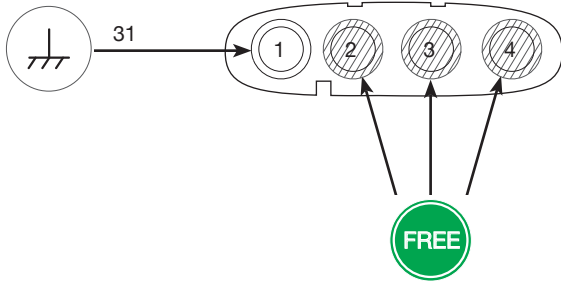

I_{max}=16A



I_{max}=16A



SuperSeal
4 pin

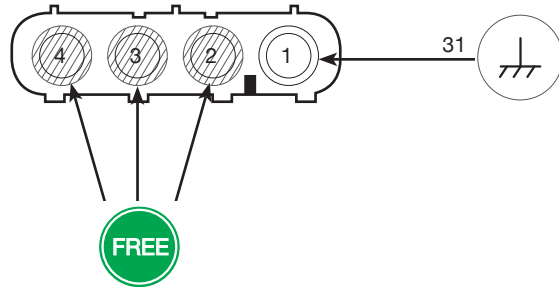
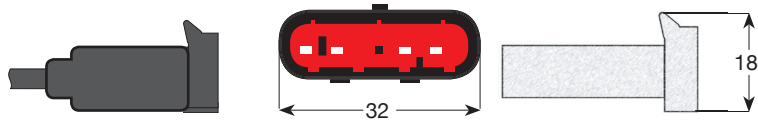

SPARE PART NO.: 15-7002-094

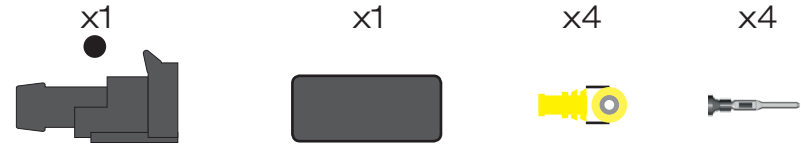

SuperSeal
4 pin

- 1.
- 2.
- 3.
- 4.
- 5.

I_{max}=16A



I_{max}=16A



SuperSeal
6 pin

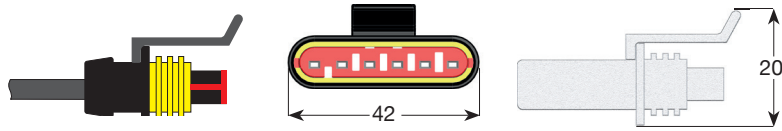

SPARE PART NO.: 15-7002-104

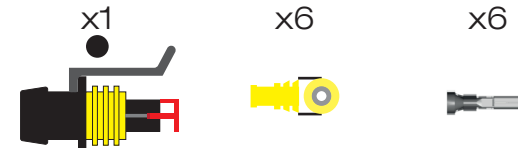

SuperSeal
6 pin

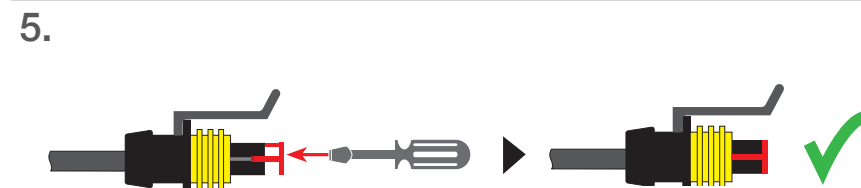
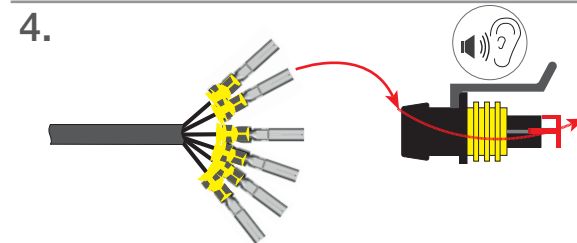
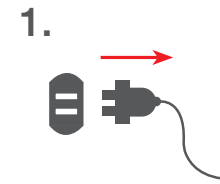
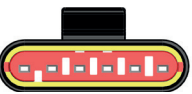
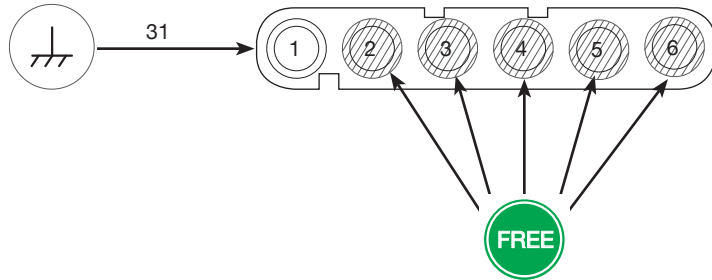
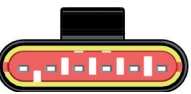

I_{max}=16A



I_{max}=16A



SuperSeal
6 pin

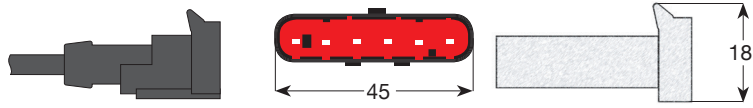

SPARE PART NO.:15-7002-114

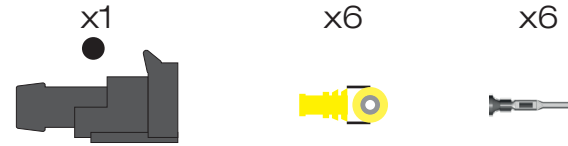

SuperSeal
6 pin

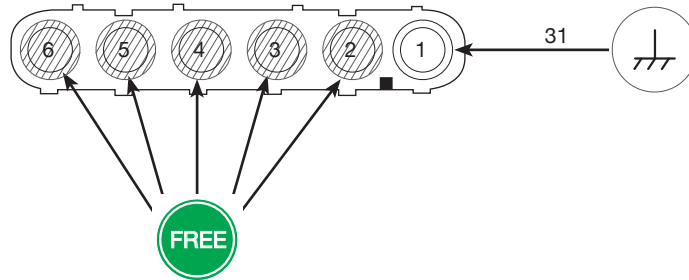

1. Step 1: Insert the black plastic housing into the red PCB.
2. Step 2: Strip the outer insulation from the wires.
3. Step 3: Strip the insulation from the individual wires. A callout shows a 35mm length of outer insulation and a 5mm length of inner insulation.
4. Step 4: Insert the wires into the crimp sleeves.
5. Step 5: Crimp the crimp sleeves onto the wires. Then, insert the crimped wires into the housing. A green checkmark indicates the final assembly is complete.



I_{max}=16A



I_{max}=16A

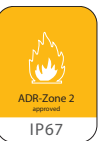

DEUTSCH 2 pin

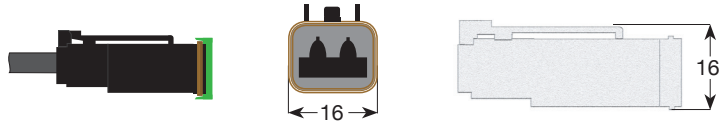

SPARE PART NO.: 15-7002-135



DEUTSCH 2 pin

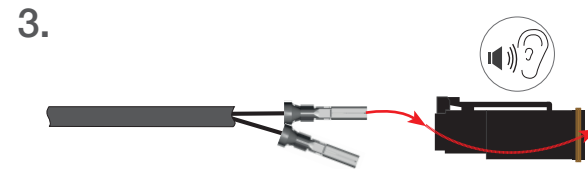
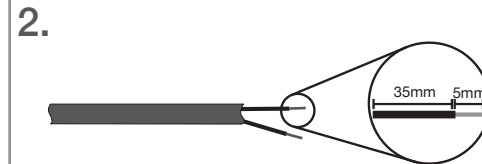
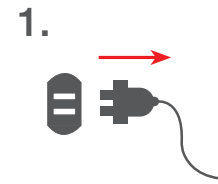
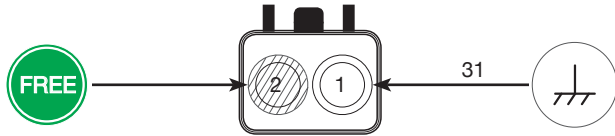

I_{max}=13A



I_{max}=13A



DEUTSCH 2 pin

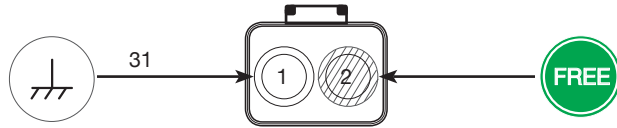
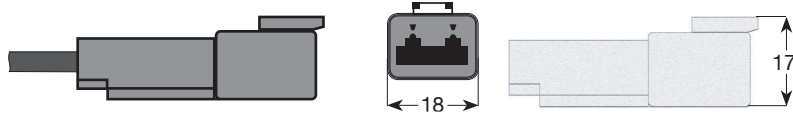

I_{max}=13A

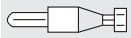

SPARE PART NO.: 15-7002-125



DEUTSCH 2 pin

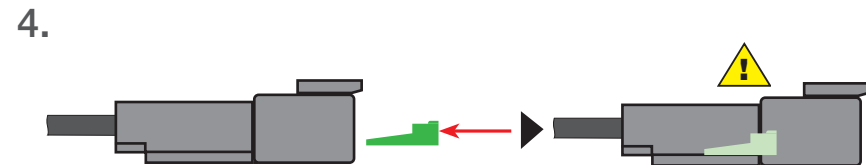
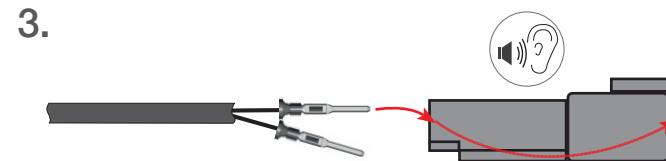
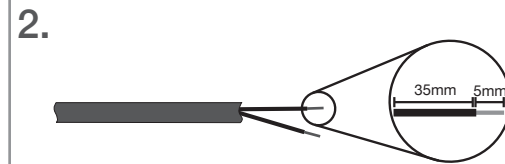
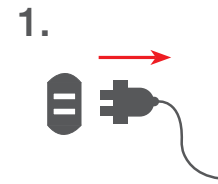

I_{max}=13A



DEUTSCH
4 pin

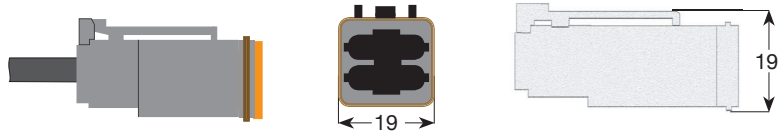

SPARE PART NO.: 15-7002-155



DEUTSCH
4 pin

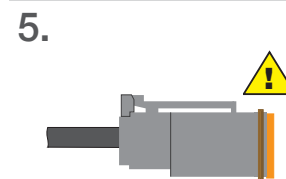
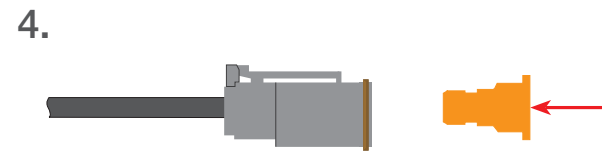
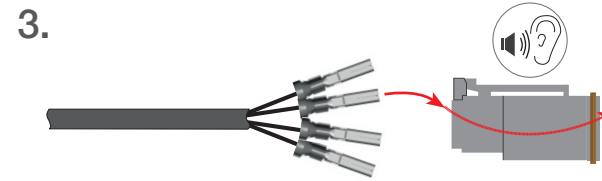
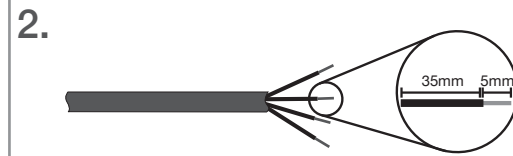
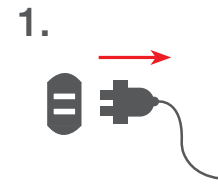
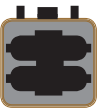
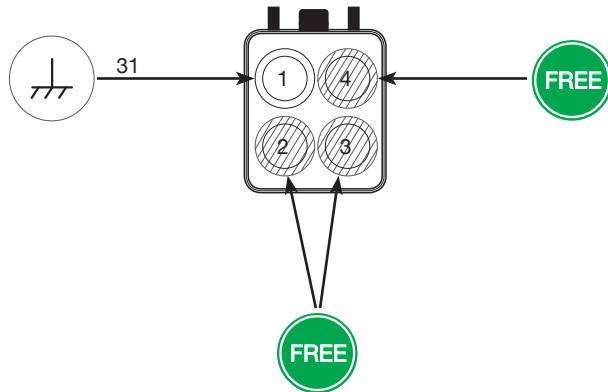

I_{max}=13A



I_{max}=13A



DEUTSCH 4 pin

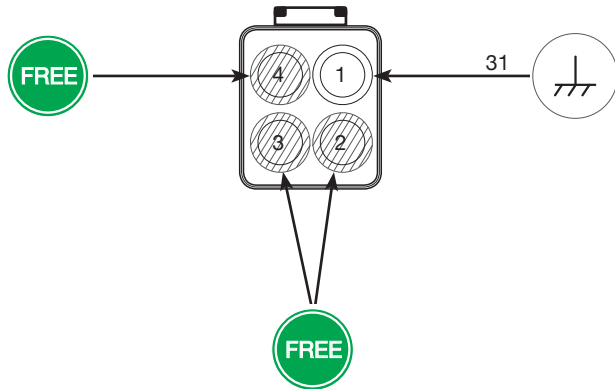
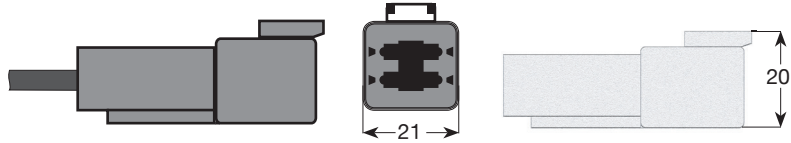

I_{max}=13A



SPARE PART NO.: 15-7002-145

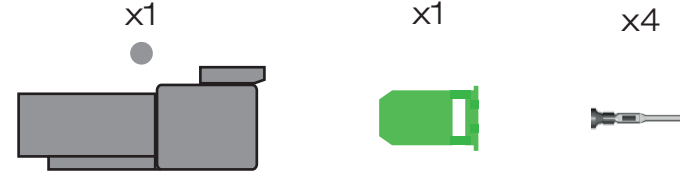

DEUTSCH 4 pin



- 1.
- 2.
- 3.
- 4.
- 5.

I_{max}=13A

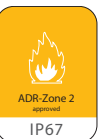

Standard connector 3600 8 pin

3600
8 pin

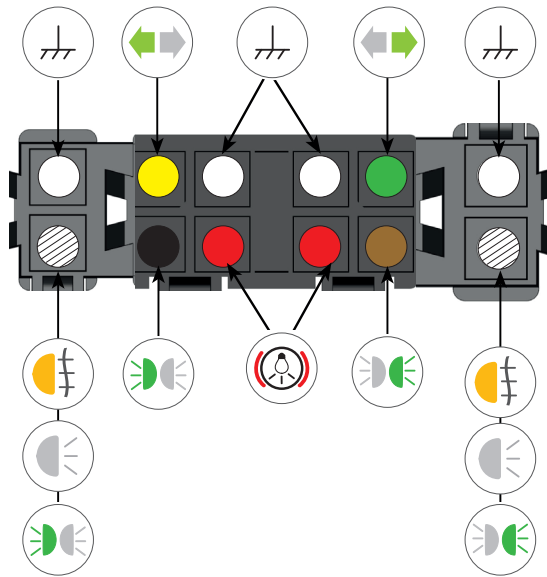
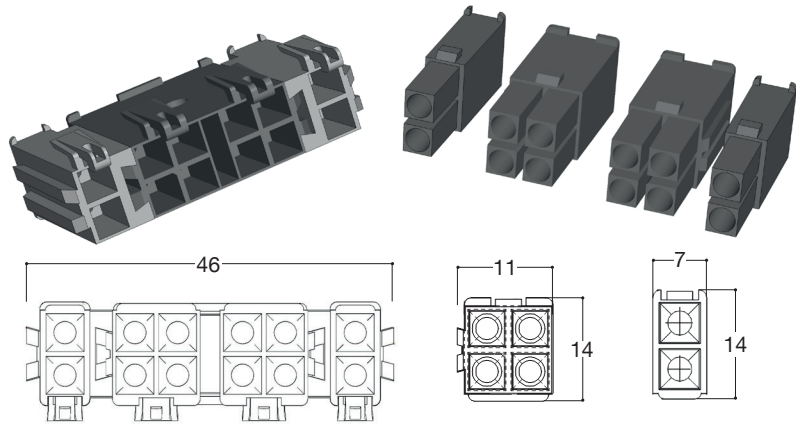

$I_{max}=16A$

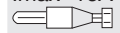

Standard connector 3612 12 pin

3612
12 pin

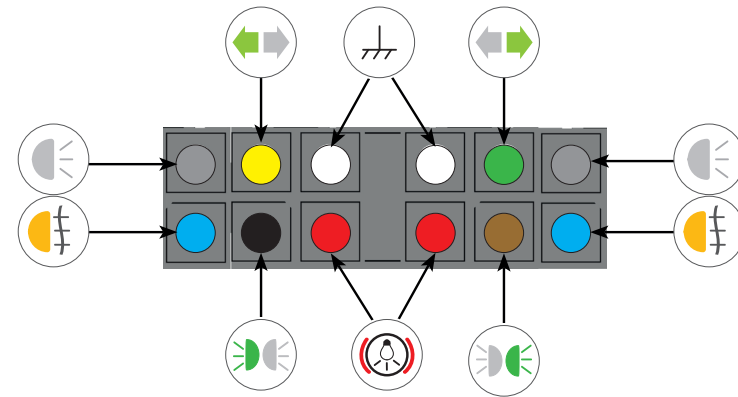
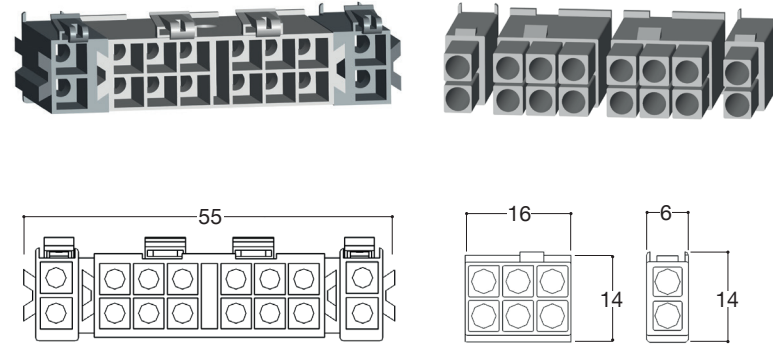

$I_{max}=16A$



Caravan connector 3650 16 pin

3650
16 pin

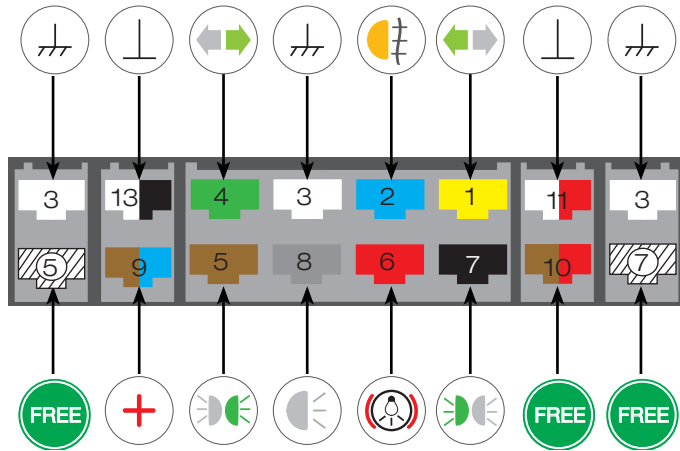
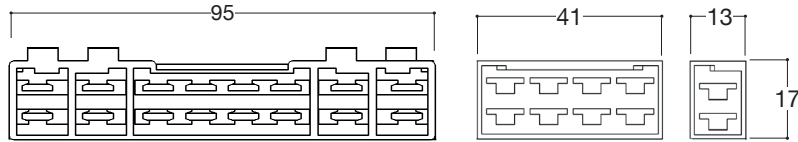

$I_{max}=25A$



ISO 1185 7 pin, ISO 3731 7 pin

ISO 1185
7 pin

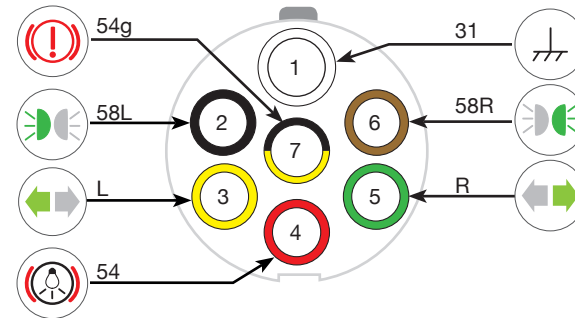
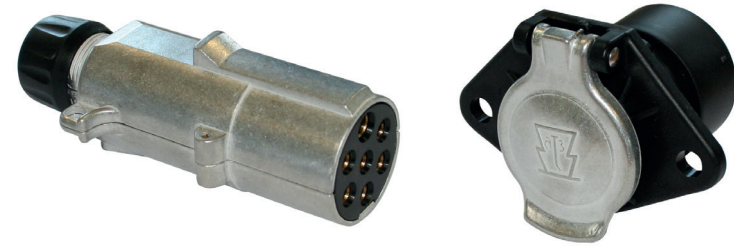

ISO 3731
7 pin

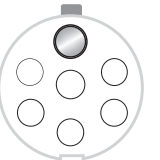
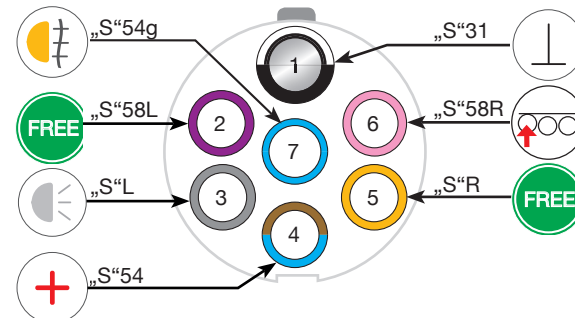
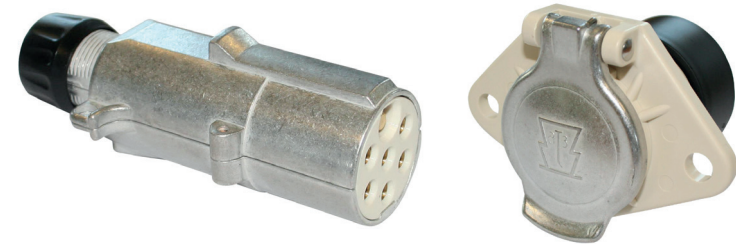

ISO 12098 13 pin

ISO
12098
13 pin

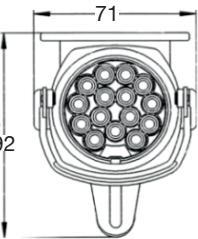
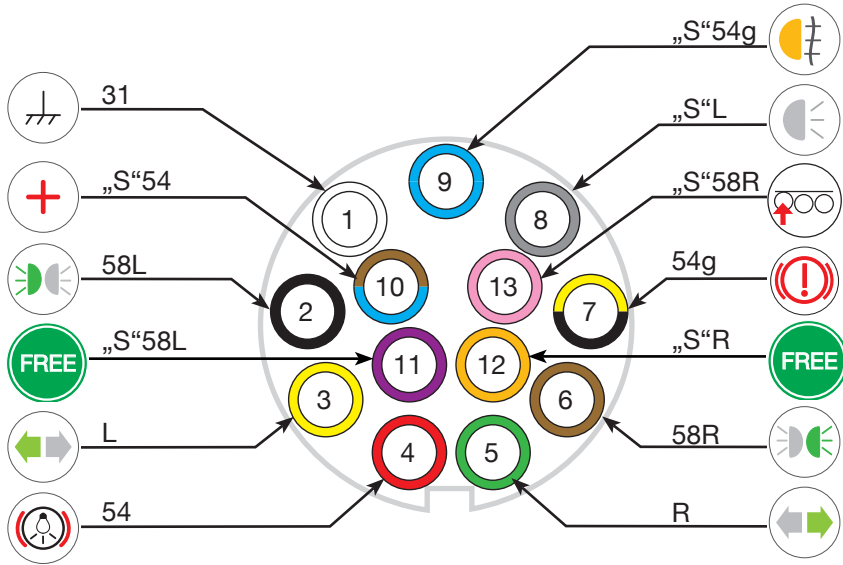

ISO 12098 15 pin

ISO
12098
15 pin

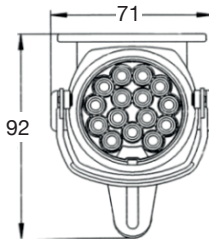
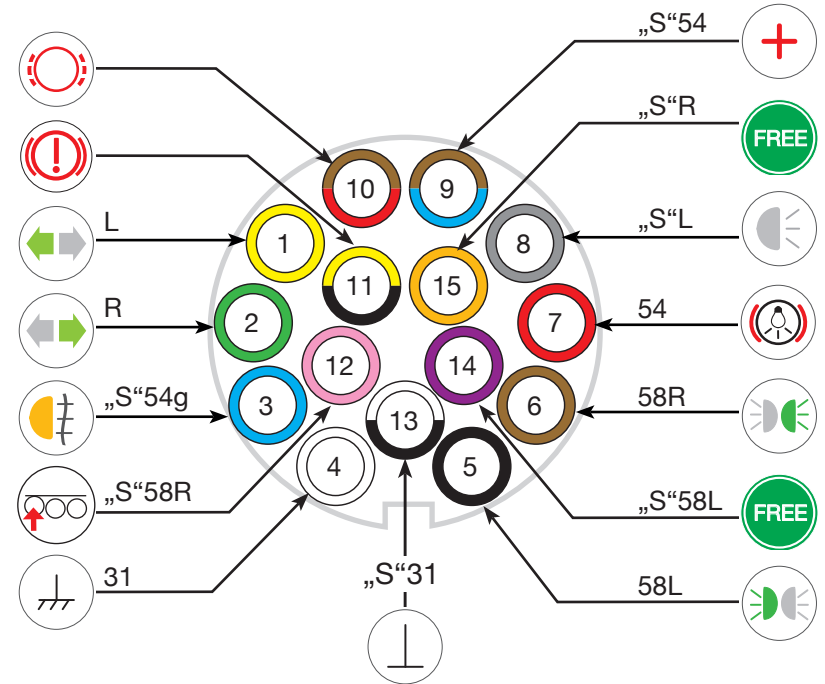

ISO 1724 7 pin

ISO 1724
7 pin

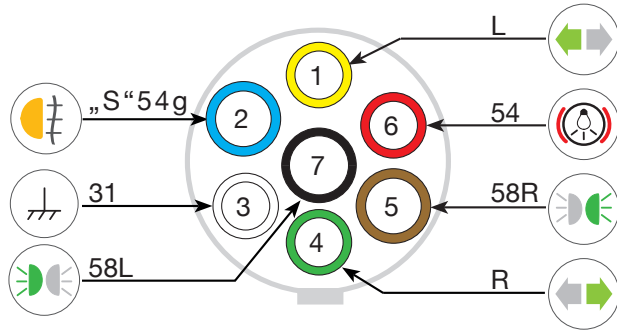

ISO 11446 13 pin, ISO 11446 8 pin

ISO 11446
13 pin

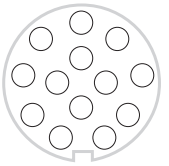
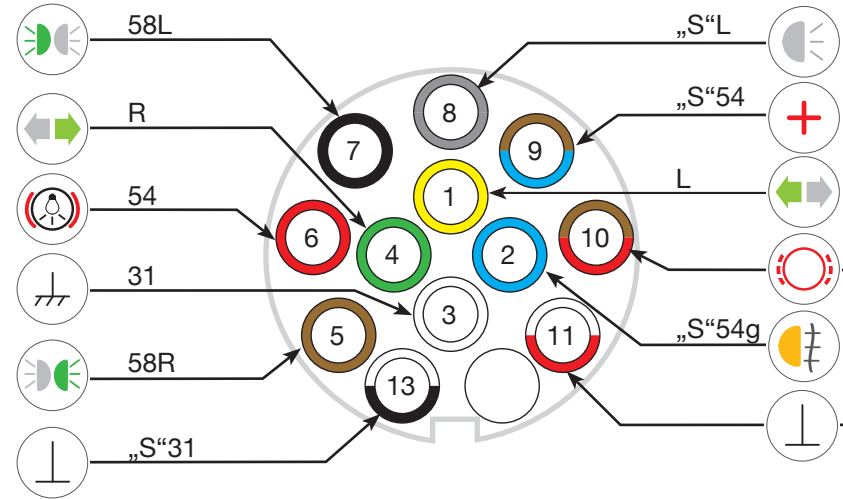

ISO 11446
8 pin

DIN 9680 3 pin

DIN 9680
3 pin

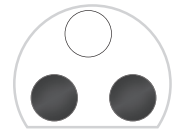
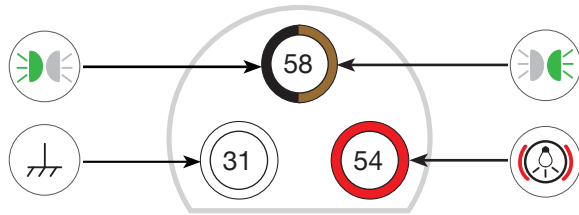

VBG 14 pin

VBG
14 pin

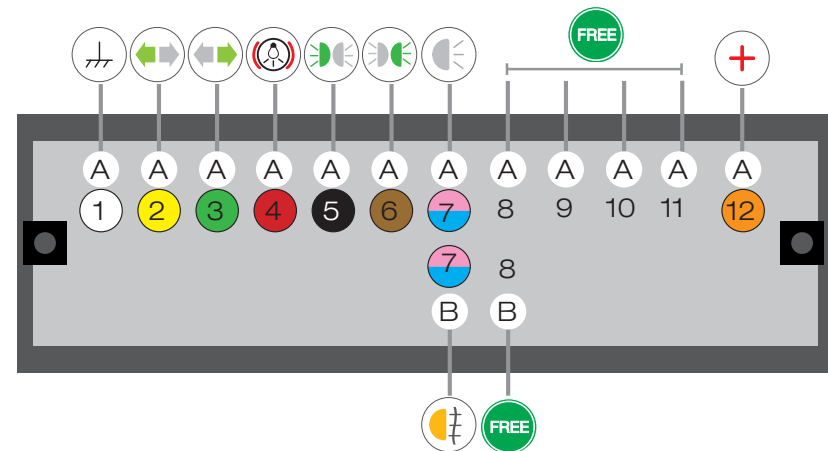

THE ART OF LIGHTS

ASPÖCK SYSTEMS GMBH

Enzing 4 | 4722 Peuerbach | AUSTRIA

Phone: +43 72 76 / 26 70-0 | Fax: DW 1199

E-Mail: office@aspoeck.com | www.aspoeck.com



Management
System
ISO 9001:2008
VDA 6.1

www.tuv.com
ID: 8195017459

Part N.: 10-0350-027
Printing errors, technical changes,
as well as picture changes reserved.
Picture credits: All Illustrations and photographs
© Aspöck Systems GmbH 03/2016



Technik, U.S.A.,
Broschüre, MM, AAW 13/001
D. Nr. 21.02.2016
D. Nr. 21.02.2016
Version: 02